

# Contents

Magazine (1) .....	2
Magazine (2) .....	4
Cables for carriage/Drum sensor .....	6
Motors and Sensors .....	8
Guides .....	10
Rollers (1) .....	12
Rollers (2) .....	14
Buffer Guide .....	16
Laser and Car system .....	18
Punch .....	20
Knife .....	22
Electronics (1) .....	24
Electronics (2) .....	26
Chassis .....	28
Panels.....	30
Type I Processor (1) .....	32
Type I Processor (2) .....	34
Type I Activator rack (3) .....	36
Type I Stabilizer rack (4) .....	38
Type II Processor (1) .....	40
Type II Processor (2) .....	42
Type II Processor (3) .....	44
Type III Processor (1) .....	46
Type III Processor (2) .....	48
Type III Processor (3) .....	50
RECOMMENDED SPARE PARTS KIT .....	52
Accessories/Kits: .....	54
Explanation .....	55

*Note: Any changes since the last revision will in this section will be highlighted.*

*New: "C" column in sparepart tables indicates consumable parts*

### Magazine (1)

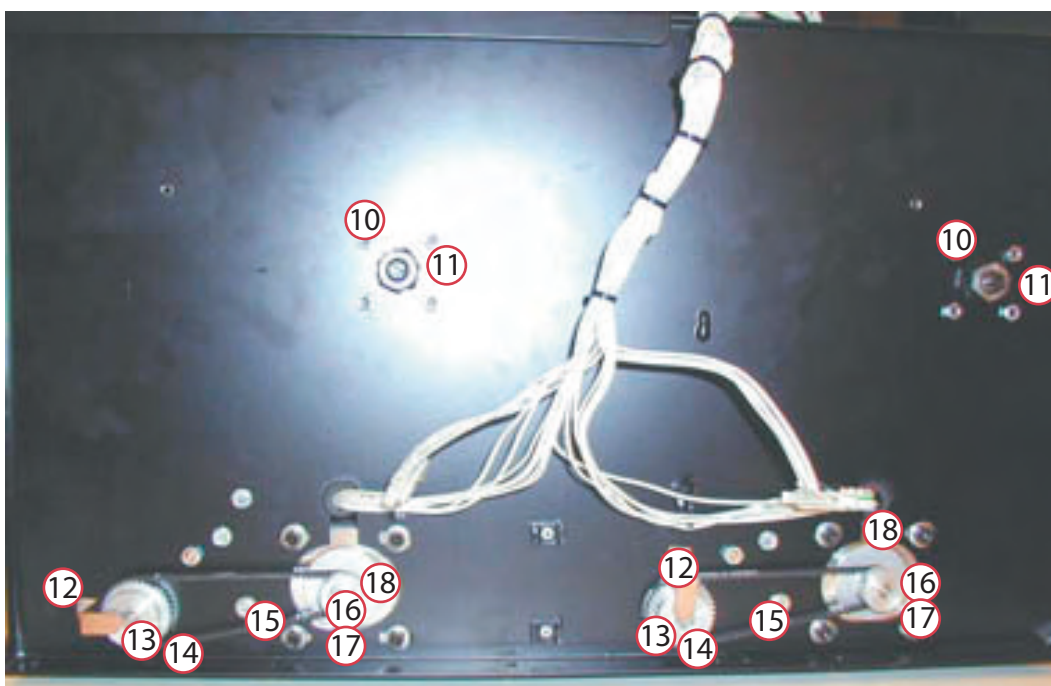
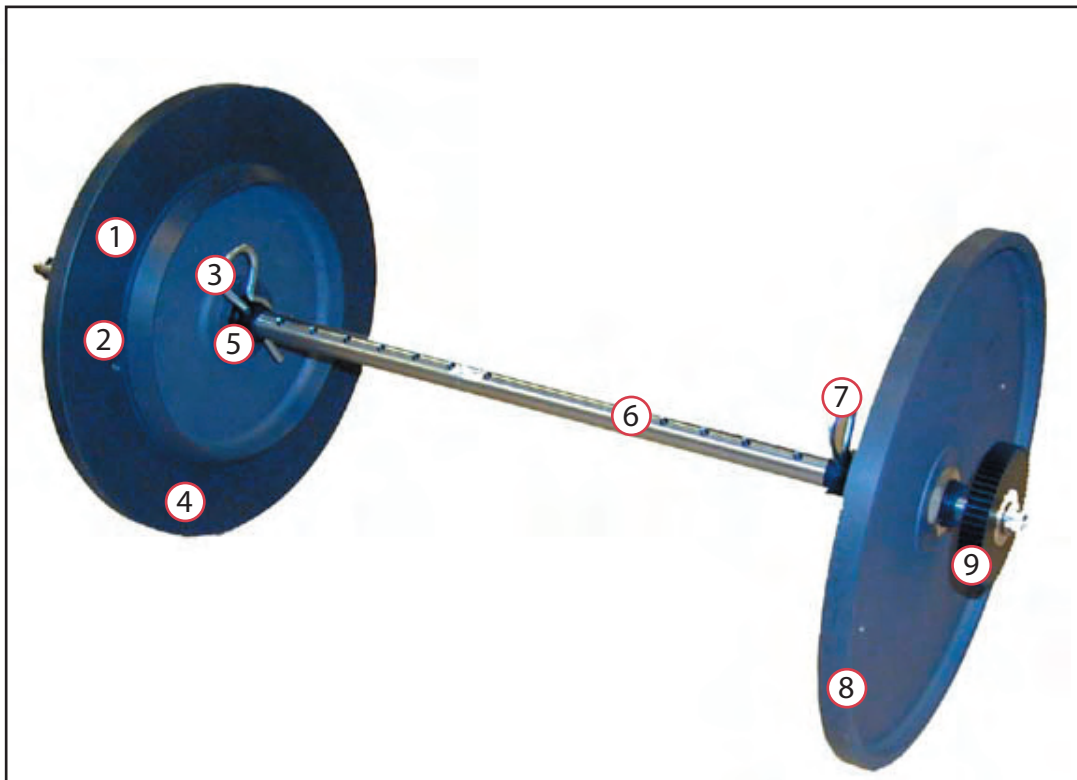

<i>Pos.</i>	<i>Part No.</i>	<i>Designation</i>	<i>Notes</i>	<i>C</i>
01	063-645-000	Thumb screw	(Not shown)	
02	052-052-000	Spike		
03	035-414-000	Spring split		
05	057-807-025	Bushing with threads		
06	054-968-000	Axle for spool shaft		
07	035-414-000	Spring split		
09	018-006-000	Gear		
10	459-715-000	Adjuster for shaft		
11	463-019-024	Locknut for adjuster		
12	035-263-000	Ground clip for pulley		
13	452-105-000	Pulley for belt		
14	462-323-000	Grub screw for pulley		
15	452-110-000	Belt for stepper motor		
16	018-003-000	Belt drive for stepper motor		
17	462-304-000	Grub screw for stepper motor		
18	067-686-070	Stepper motor with plug (M3 & M4)		
	011-624-003	Adjusting Spanner for spool shaft		

Magazine (2)

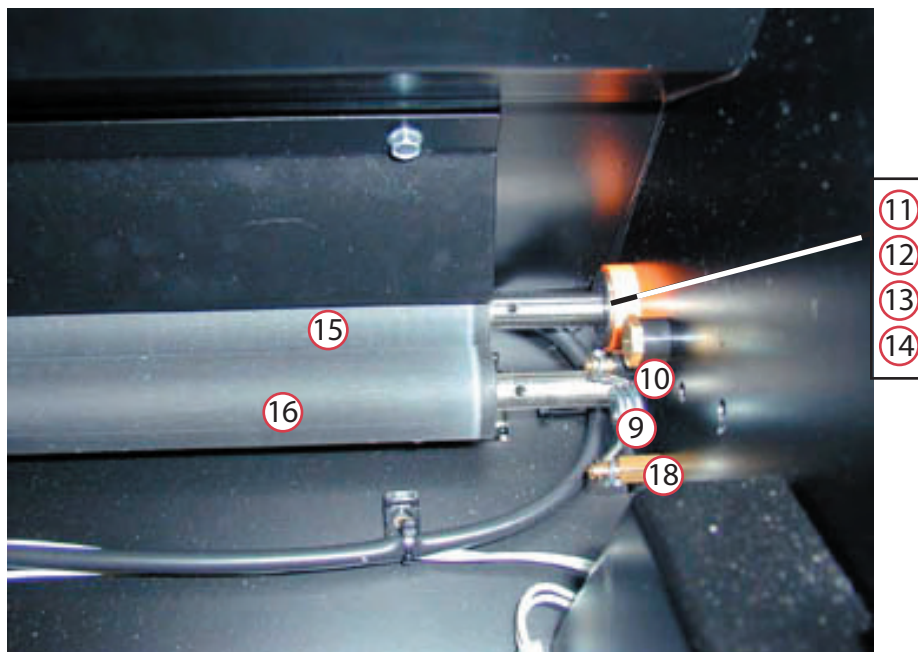
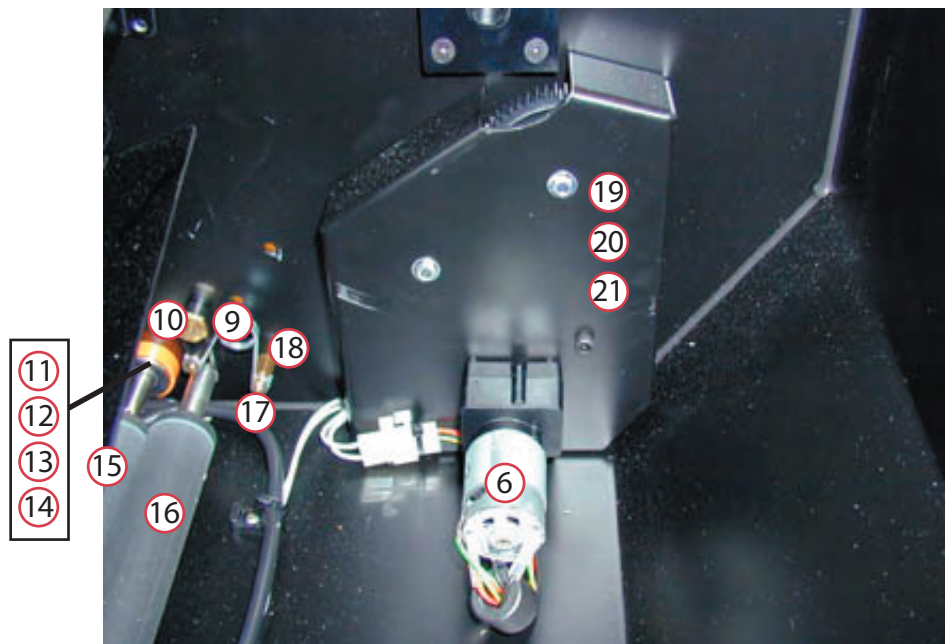
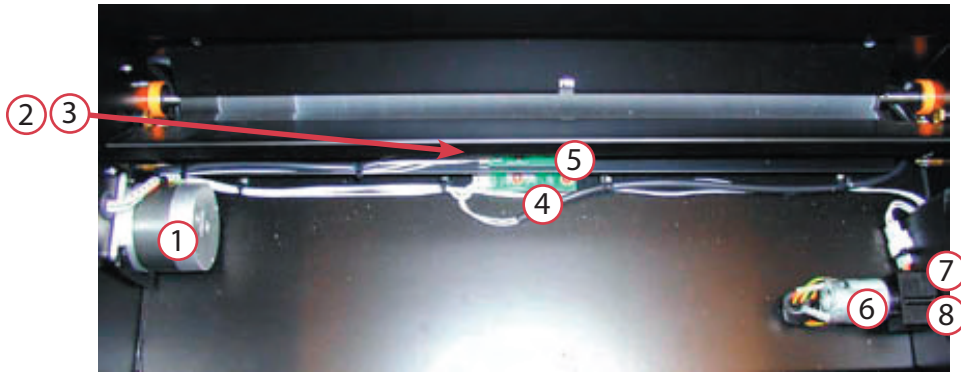

<b>Pos.</b>	<b>Part No.</b>	<b>Designation</b>	<b>Notes</b>	<b>C</b>
01	067-686-070	Stepper motor with plug	(M3 & M4)	
02	021-400-003	Guide for loader magazine A		
03	021-399-003	Guide for loader magazine B		
04	212-806-000	<b>Park Sensor</b> <i>Consists of:</i>	(S1 & S2)	
	212-805-000	LED Transmitter		
	296-716-000	Receiver		
05	212-806-000	<b>Empty roll sensor upper and lower</b> <i>Consists of:</i>	(S3 & S4)	
	212-805-000	LED Transmitter		
	296-716-000	Receiver		
06	067-051-000	DC Motor with plug	(M1 & M2)	
07	030-978-000	Gear for DC motor		
08	057-805-000	Hub for DC motor gear		
09	035-232-023	Spring for pressure roller		C
10	043-129-000	Lever for pressure roller		
11	451-009-000	Ball bearing for magazine drive roller		
12	459-067-000	Ball bearing spring		
13	029-898-000	Container for spring		C
14	470-700-000	C-clip for drive roller		
15	022-612-000	Drive roller for magazine		
16	022-611-000	Pressure roller for magazine		C
17	470-300-000	Retainer for spring		
18	011-415-000	Support for spring		
19	030-995-000	Gear for return drive		
20	011-418-000	Axle for return drive gear		
21	470-700-000	C-clip for gear		



**Cables for carriage/Drum sensor**

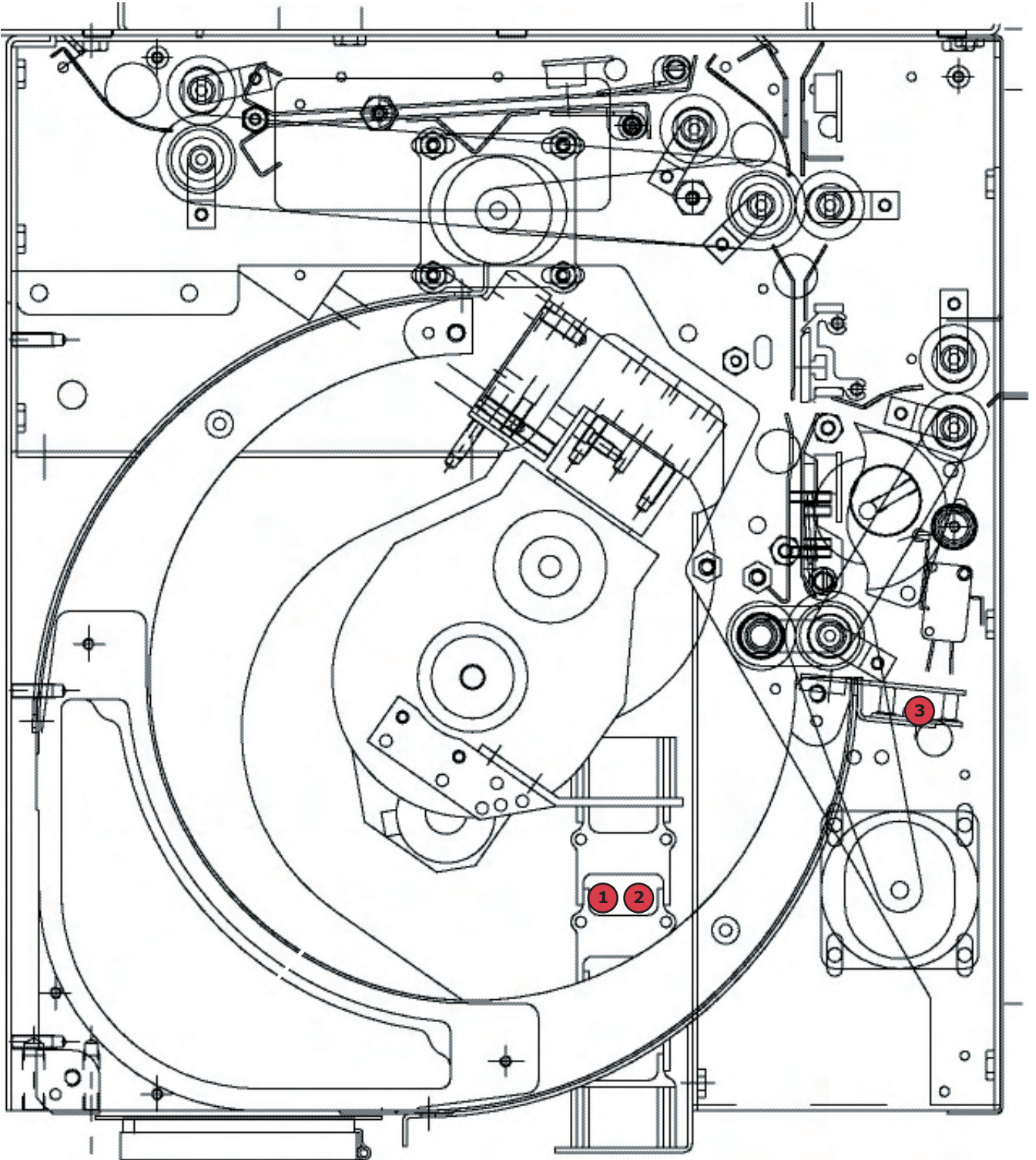

<b>Pos.</b>	<b>Part No.</b>	<b>Designation</b>	<b>Notes</b>	<b>C</b>
1	6610228800	Cable for carriage		
2	067-224-000	Coax cable for laserdriver		
3	296-723-000	Drum Sensor (S8)		
	200-992-000	Drum sensor adjustment kit	Read TI. 05	

**Motors and Sensors**

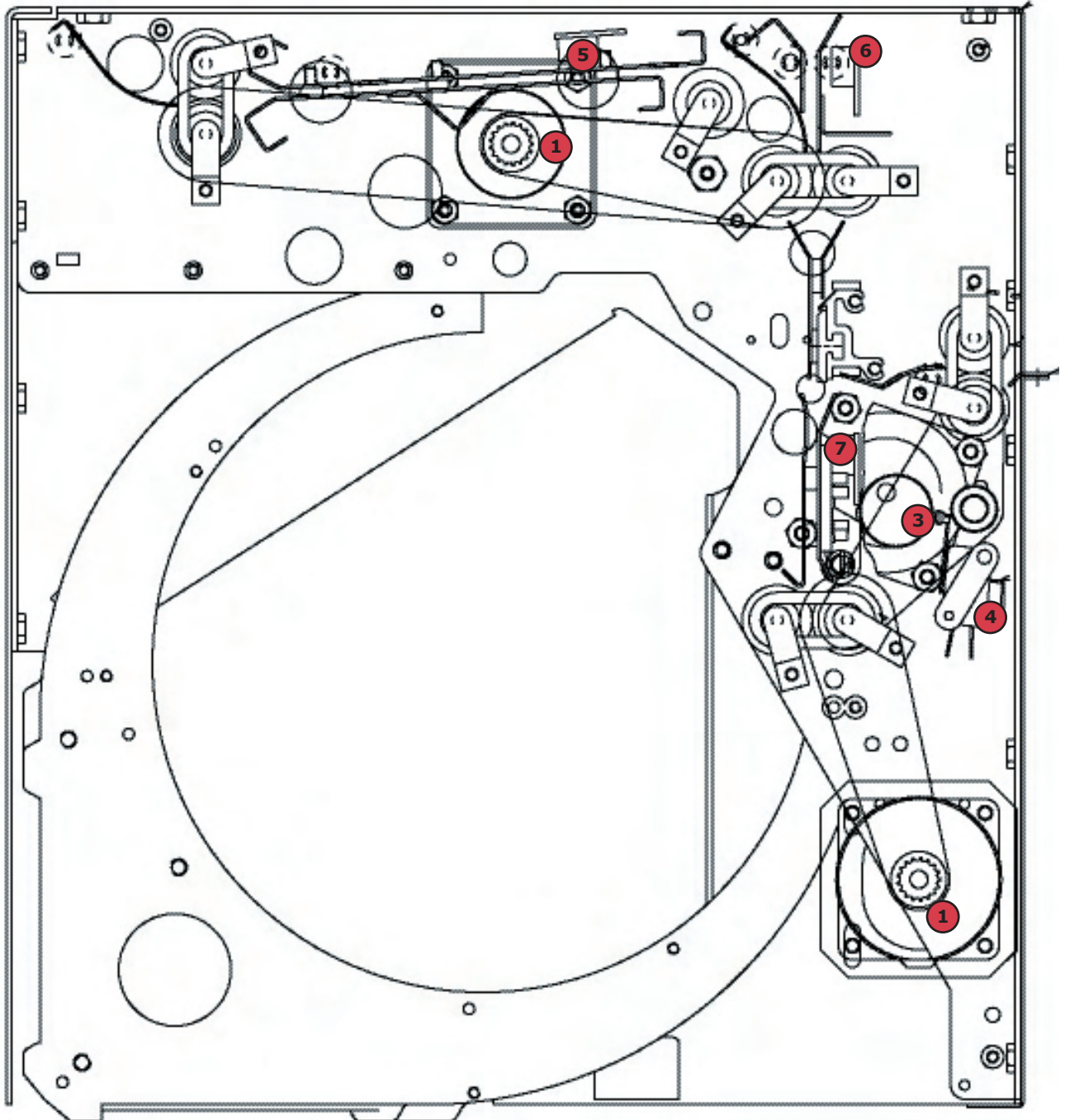



<b>Pos.</b>	<b>Part No.</b>	<b>Designation</b>	<b>Notes</b>	<b>C</b>
01	079-028-000	<b>Stepmotor Assy.</b> <i>Consists of:</i>		
	067-049-045	Stepmotor		
	018-003-000	Pulley Z17		
03	011-436-000	Cam for switchguide		
04	411-160-000	Microswitch for switch guide		
05	296-734-000	Feed Sensor A (S5)		
06	296-734-000	Feed Sensor B (S6)		
07	296-734-000	Jam Sensor (S7)		

**Guides**

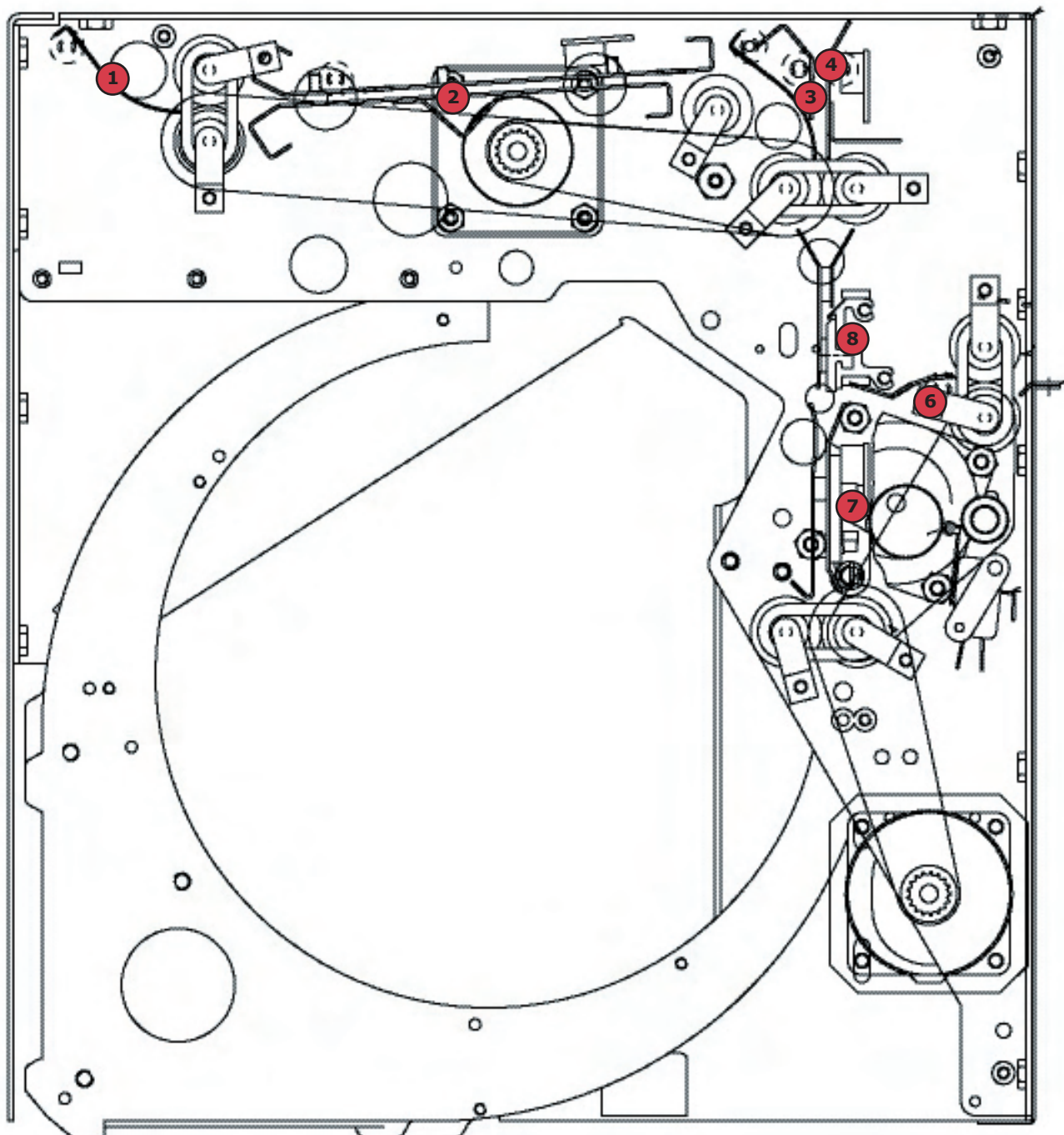

<b>Pos.</b>	<b>Part No.</b>	<b>Designation</b>	<b>Notes</b>	<b>C</b>
01	021-411-033	Guide P		
02	021-389-003	Guide Q Upper		
	021-388-033	Guide R Lower		
03	021-391-033	Guide S		
04	021-392-033	Guide T		
06	021-394-033	Guide Z		
07	079-100-000	<b>Switchguide Assy.</b> <i>Consists of:</i>		
	021-396-033	Guide for switchguide		
	048-892-003	Switch guide base		
	035-287-024	Spring for switchguide		
	053-035-000	Axel for switchguide		
	296-734-000	Reflex sensor		
	055-222-000	Bushing Ø6,15 plastic		C
08	079-101-000	<b>Knife guide Assy</b> <i>Consists of:</i>		
	014-010-000	Aluminium profile		
	021-397-033	Silver guide V		
	021-398-003	Black guide W		
	048-893-000	Cutting surface		

**Rollers (1)**

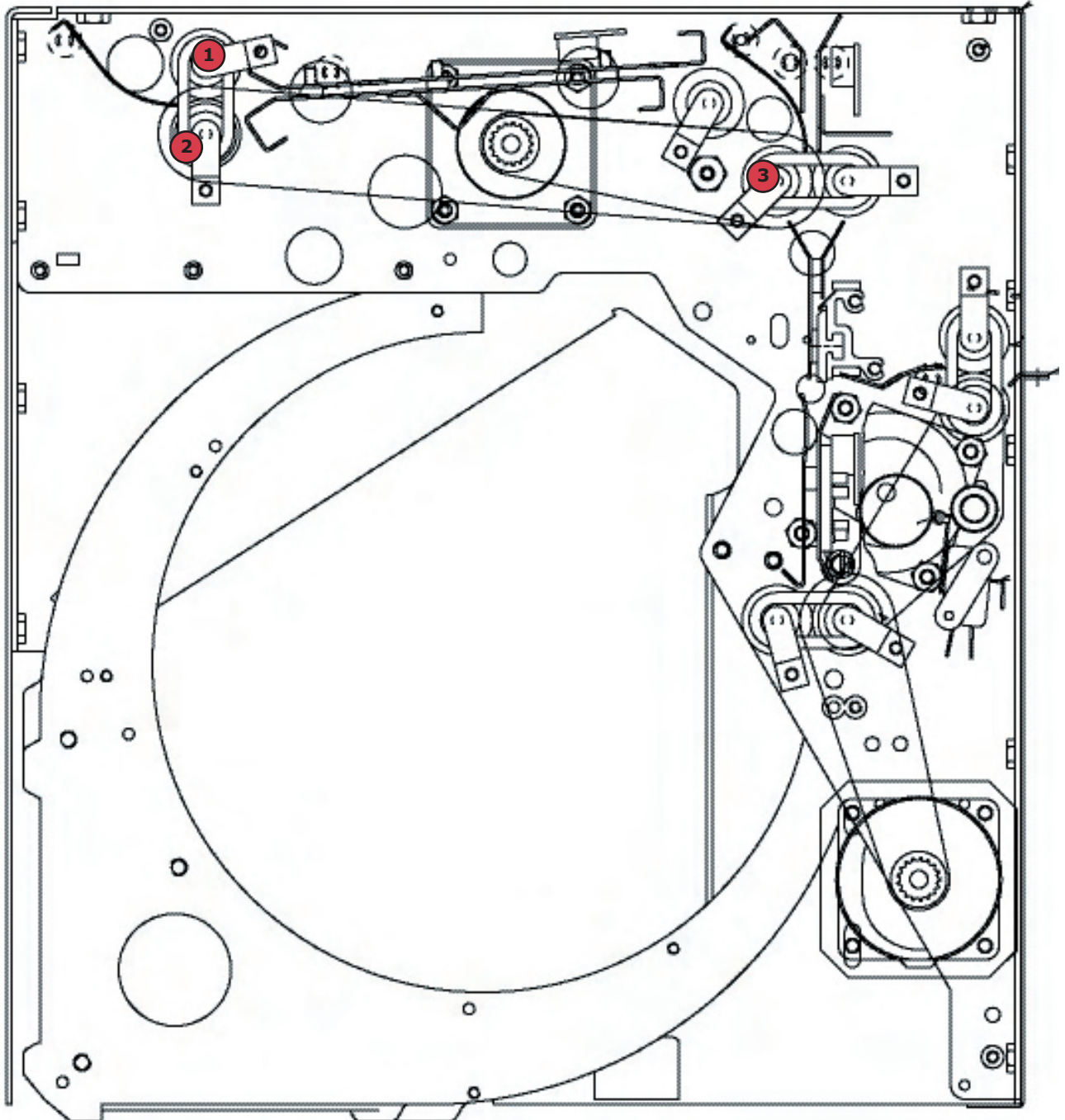



<b>Pos.</b>	<b>Part No.</b>	<b>Designation</b>	<b>Notes</b>	<b>C</b>
01	220-394-000	<b>Pressure roller Assy.</b> <i>Consists of:</i>		C
	022-606-000	Roller		
	035-263-000	Ground clip		
	055-388-000	Plastic spacer with groove		C
	060-070-000	Plastic spacer for spring		
	470-700-000	C-clip		
02	220-393-000	<b>Drive roller assy.</b> <i>Consists of:</i>		C
	022-606-000	Roller		
	030-151-000	Gear		
	035-263-000	Ground clip		
	060-070-000	Plastic spacer for spring		
	452-107-000	Pulley		
	470-700-000	C-clip		
	459-067-000	Orange plastic bearing		
	035-182-000	Spring		C
03	220-393-000	<b>Drive roller assy.</b> <i>Consists of:</i>		C
	022-606-000	Roller		
	030-151-000	Gear		
	035-263-000	Ground clip		
	060-070-000	Plastic spacer for spring		
	452-107-000	Pulley		
	470-700-000	C-clip		
	459-067-000	Orange plastic bearing		
	035-182-000	Spring		C

**Rollers (2)**

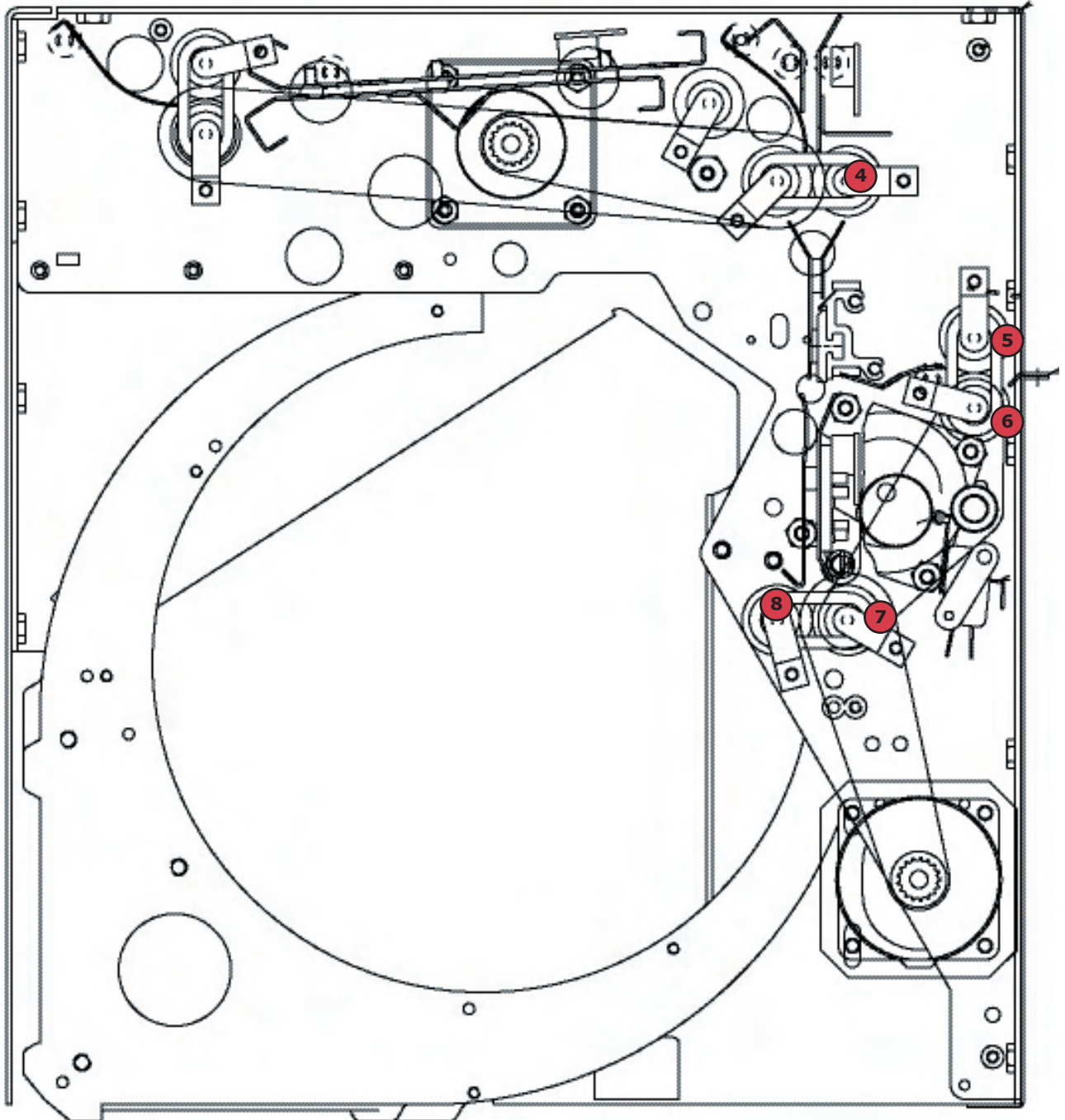

<b>Pos.</b>	<b>Part No.</b>	<b>Designation</b>	<b>Notes</b>	<b>C</b>
04	220-394-000	<b>Pressure roller Assy.</b>		C
		<i>Consists of:</i>		
	022-606-000	Roller		
	035-263-000	Ground clip		
	055-388-000	Plastic spacer with groove	C	
	060-070-000	Plastic spacer for spring		
05	220-394-000	<b>Pressure roller Assy.</b>		C
		<i>Consists of:</i>		
	022-606-000	Roller		
	035-263-000	Ground clip		
	055-388-000	Plastic spacer with groove	C	
	060-070-000	Plastic spacer for spring		
06	220-395-000	<b>Drive roller Assy.</b>		C
		<i>Consists of:</i>		
	022-606-000	Roller		
	030-990-000	Pulley		
	035-182-000	Spring		
	035-263-000	Ground clip		
	055-388-000	Plastic spacer with groove	C	
	060-070-000	Plastic spacer for spring		
07	220-396-000	<b>Drive roller assy.</b>		C
		<i>Consists of:</i>		
	022-609-000	Roller		
	030-991-000	Pulley Z28		
	035-182-000	Spring		
	035-263-000	Ground clip		
	451-102-000	One way clutch		
	060-070-000	Plastic spacer for spring		
	452-105-000	Pulley		
470-700-000	C-clip			
08	220-397-000	Pressure roller		C
	022-609-000	Roller		
	035-263-000	Ground clip		
	055-388-000	Plastic spacer with groove	C	
	060-070-000	Plastic spacer for spring		
	470-700-000	C-clip		

**Buffer Guide**

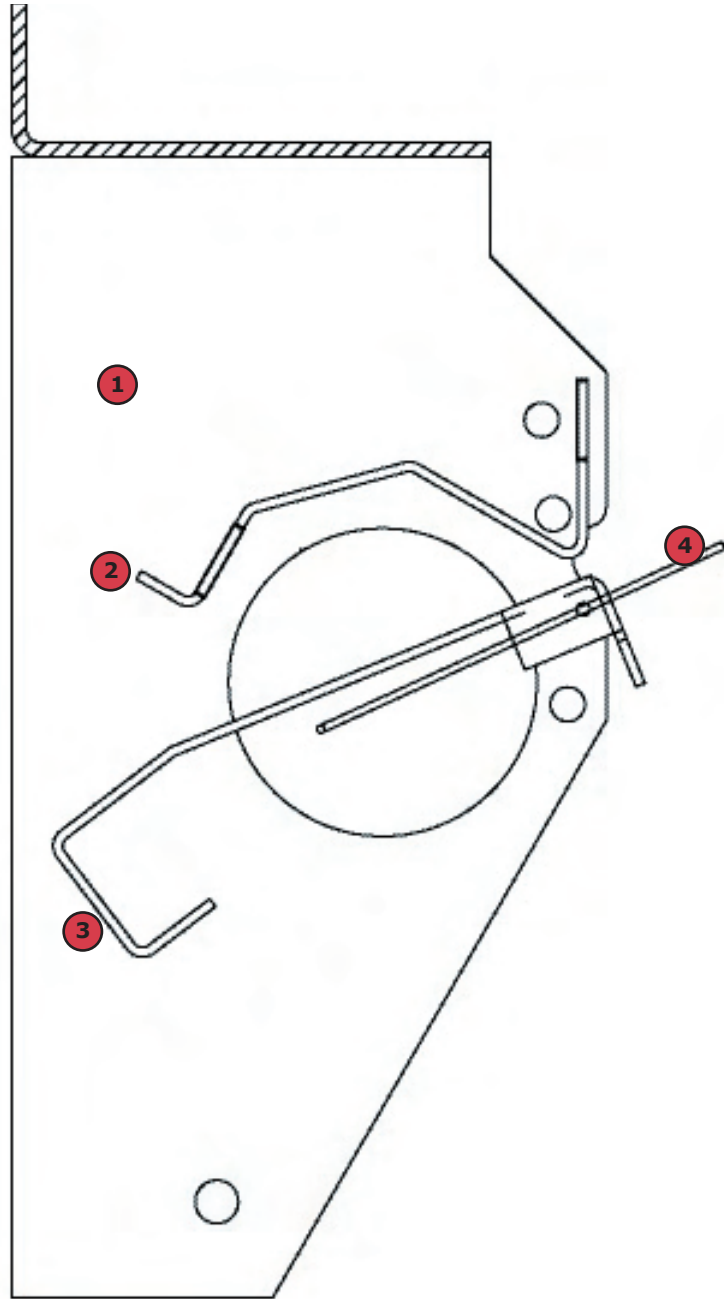



<i>Pos.</i>	<i>Part No.</i>	<i>Designation</i>	<i>Notes</i>	<i>C</i>
	079-144-000	Buffer guide Complete		
01	048-986-003	Buffer guide Assy.		
02	048-987-033	Guide for buffer		
03	048-988-003	Buffer guide		
04	035-422-000	Spring for buffer guide		

Laser and Car system

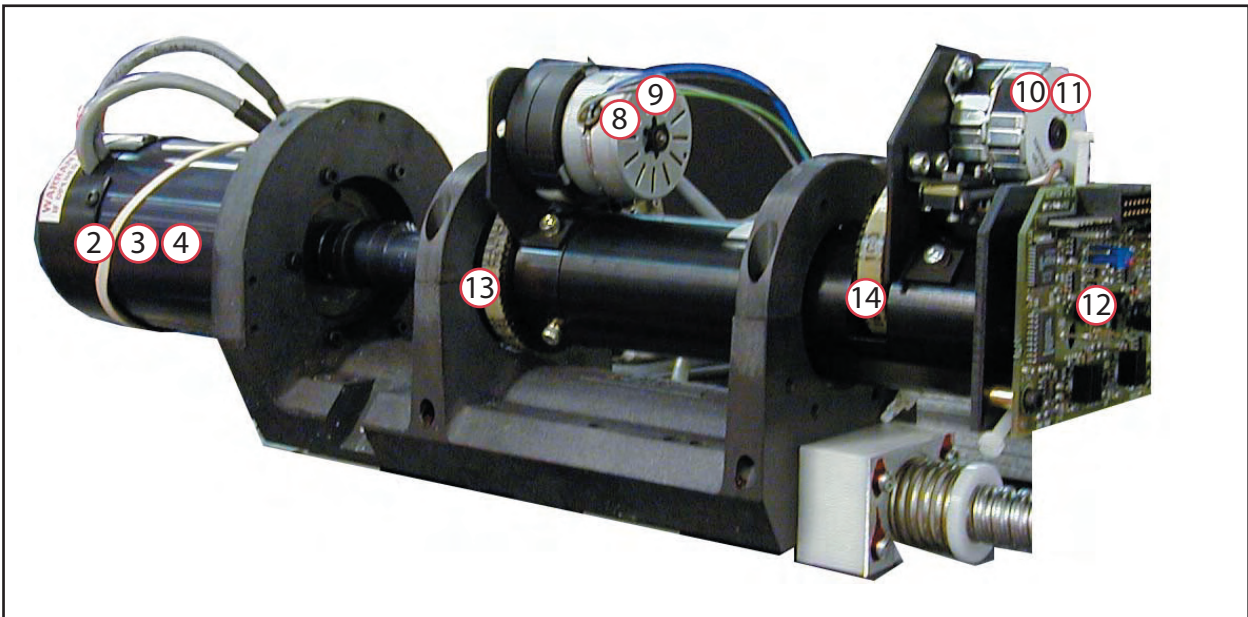
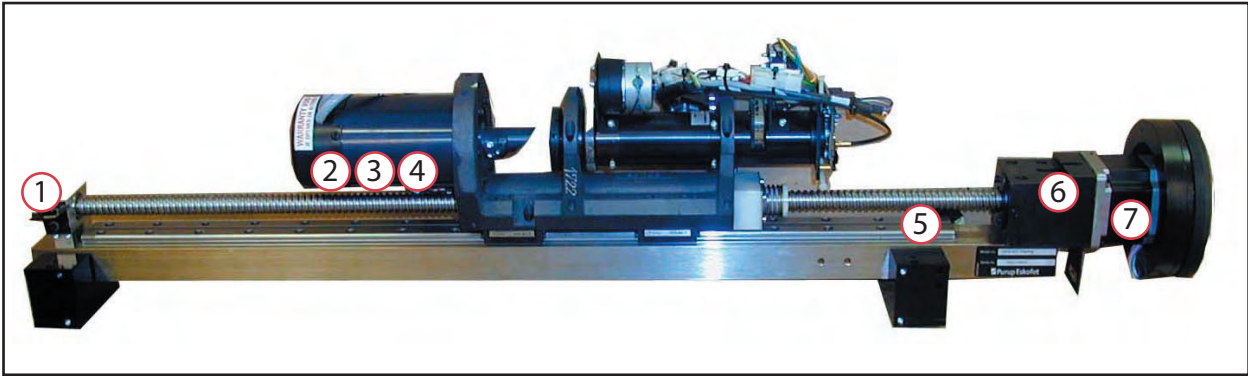

<i>Pos.</i>	<i>Part No.</i>	<i>Designation</i>	<i>Notes</i>	<i>C</i>
01	419-508-000	Carriage end switch		
02	9604400020S	Spinnermotor 20K rpm big mirror	(Read TI-41)	
03	9604400020S	Spinnermotor 20K rpm	(Read TI-41)	
04	9604400020S	Spinnermotor 30K rpm	(Read TI-41)	
05	419-508-000	Carriage index switch		
06	419-511-000	Leadscrew motor coupling		
07	9604500170	Carriage motor		
08	419-243-000	Aperture stepper motor		
09	9604500320	Aperture microswitch		
10	9604500200	Filter stepper motor		
11	9604500310	Filter microswitch		
12	419-510-000	Laser board		
	067-224-000	Coax cable for laser		
13	6620400030	Belt for iris	(not shown)	
14	6620400020	Belt for filter		
	6161400100	Grease for spindle 3g	(not shown)	C
	602344	Filterwheel and axle		

### Punch

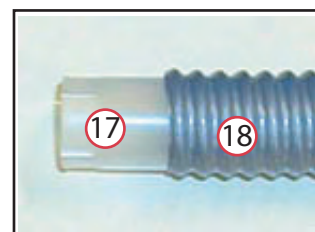
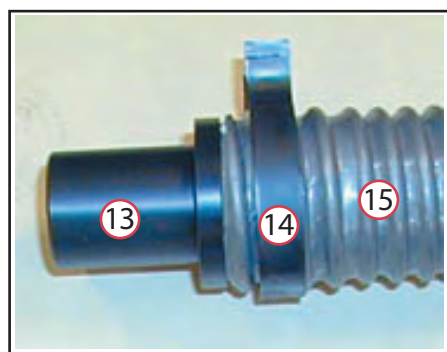
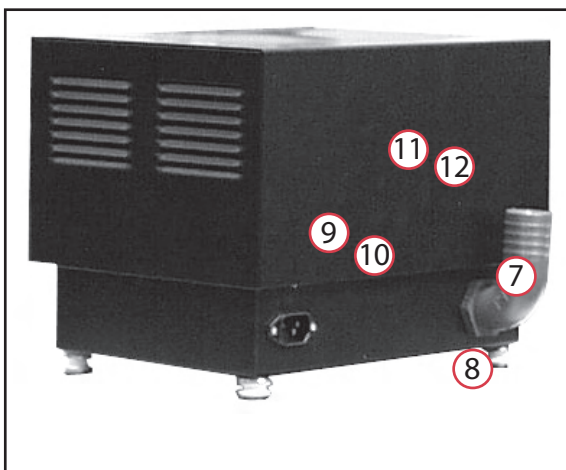
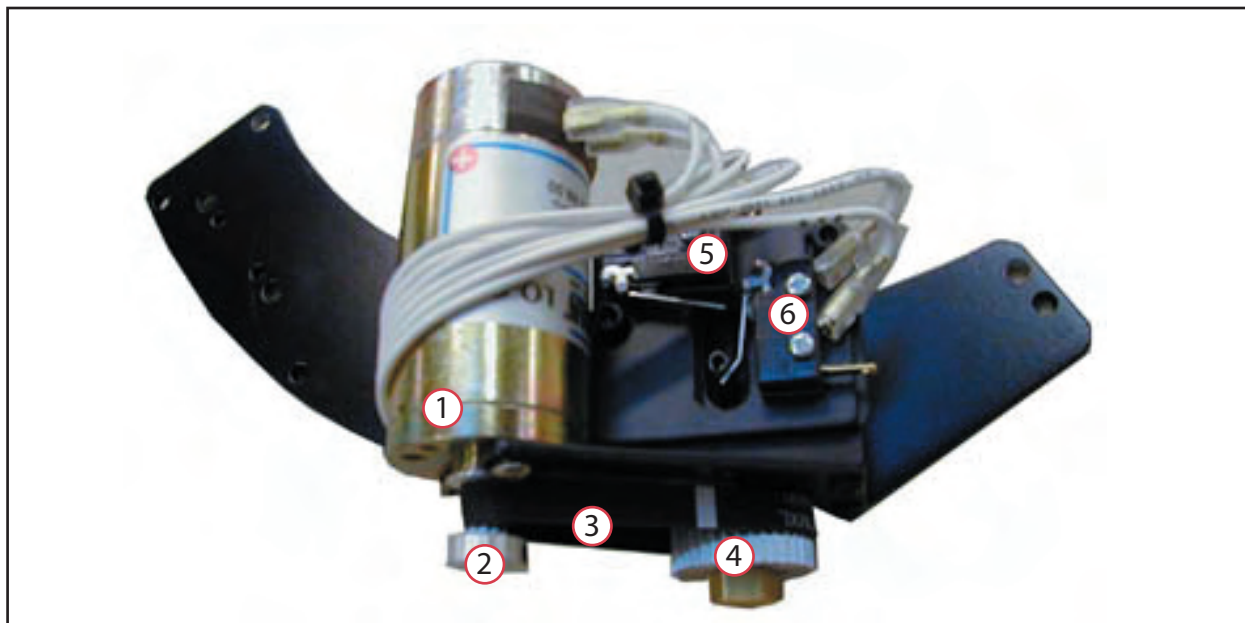



<b>Pos.</b>	<b>Part No.</b>	<b>Designation</b>	<b>Notes</b>	<b>C</b>
01	413-081-000	Motor for punch (M12 & M13)		
02	030-994-000	Gear for punch motor		
03	452-113-000	Belt for punch		
04	018-008-000	Gear for punch tool		
05	411-188-000	Micro switch straight arm	Repl. 411-118-000	
06	012-269-000	Micro switch straight bend arm		
07	459-755-000	Fitting L 1" for punch waste motor		
08	450-293-000	Vibration absorbers for punch waste motor		
09	414-976-000	Thermal switch		
10	067-645-000	Capacitor for punch waste motor		
11	295-330-000	Pump for punch waste (M18), complete	Without power plug	
12	295-332-000	Pump for punch waste w. power plug (M18)	complete	
13	014-061-000	Fitting Ø32mm for punch tool hose		
14	459-762-000	Hose clamp for Ø32mm hose		
15	403-618-000	Hose Ø32mm for punch waste		
16	079-121-000	Punch waste container inc. drawer		
16	079-124-000	Drawer for punch waste		
17	011-948-000	Fitting Ø19mm for punch tool hose		
18	403-617-000	Hose Ø19mm for punch waste		
	048-912-003	Mounting plate for landscape punch 10-12mm		
	459-761-000	Hose clamp for Ø19mm hose		
	200-963-000	Landscape punch square Assy		
	212-767-000	Portrait punch square Assy.		
	200-934-000	Landscape punch 12mm U-shape Assy.		
	200-936-000	Portrait punch 12mm U-shape Assy.		
	200-933-000	Landscape punch 10mm U-shape assy.		
	200-935-000	Portrait punch 10mm U-shape Assy.		
	014-078-000	Punch tool 12mm Square		
	011-854-000	Punch tool 12mm U-Shape		
	011-852-000	Punch tool 10mm U-Shape		
	462-713-000	Torx screw for punch		
	067-614-000	Wire Developer I/F to Punch Vac. motor	Read TI 13	

**Knife**

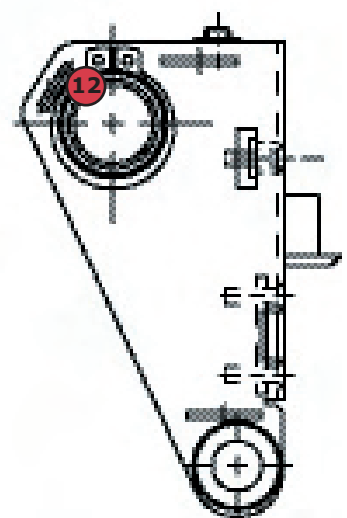
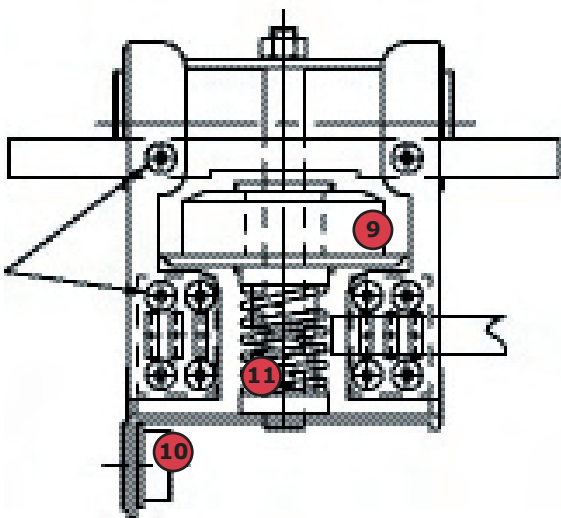
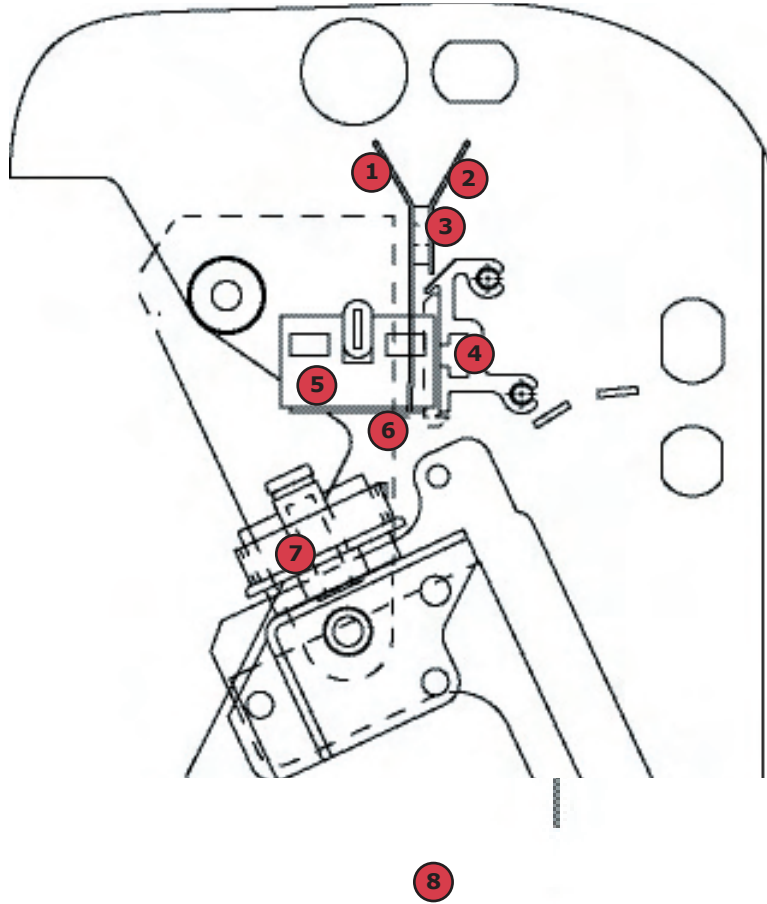

<b>Pos.</b>	<b>Part No.</b>	<b>Designation</b>	<b>Notes</b>	<b>C</b>
	212-809-000	Knife complete		
01	021-397-033	Silver guide V		
02	021-398-003	Black guide W		
03	079-101-000	Knife guide Assy	Repl. 021-397-033	
04	014-010-000	Aluminium profile		
05	296-599-000	Knife fork sensor (S9+10)		
06	048-893-000	Cutting surface		
07	452-150-000	Belt for knife	Repl. 452-101-000	
08	413-075-000	Motor for Knife (M6)		
09	047-981-000	Knife wheel	Repl. 048-893-000	
10	055-687-000	Sliding bearing		
11	035-409-000	Spring for knife		
12	470-911-000	C-clip		

Electronics (1)

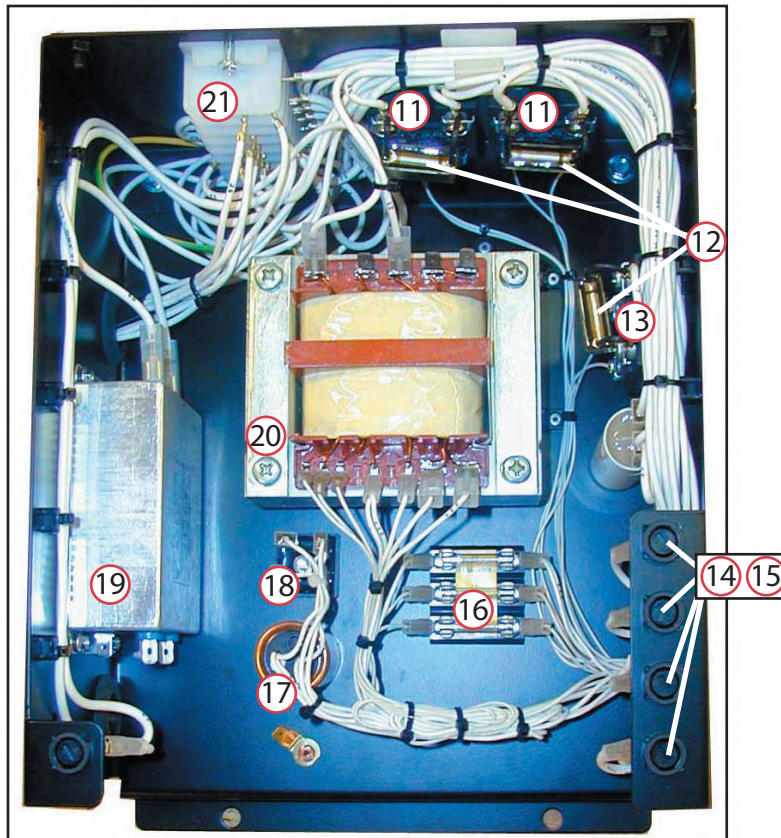
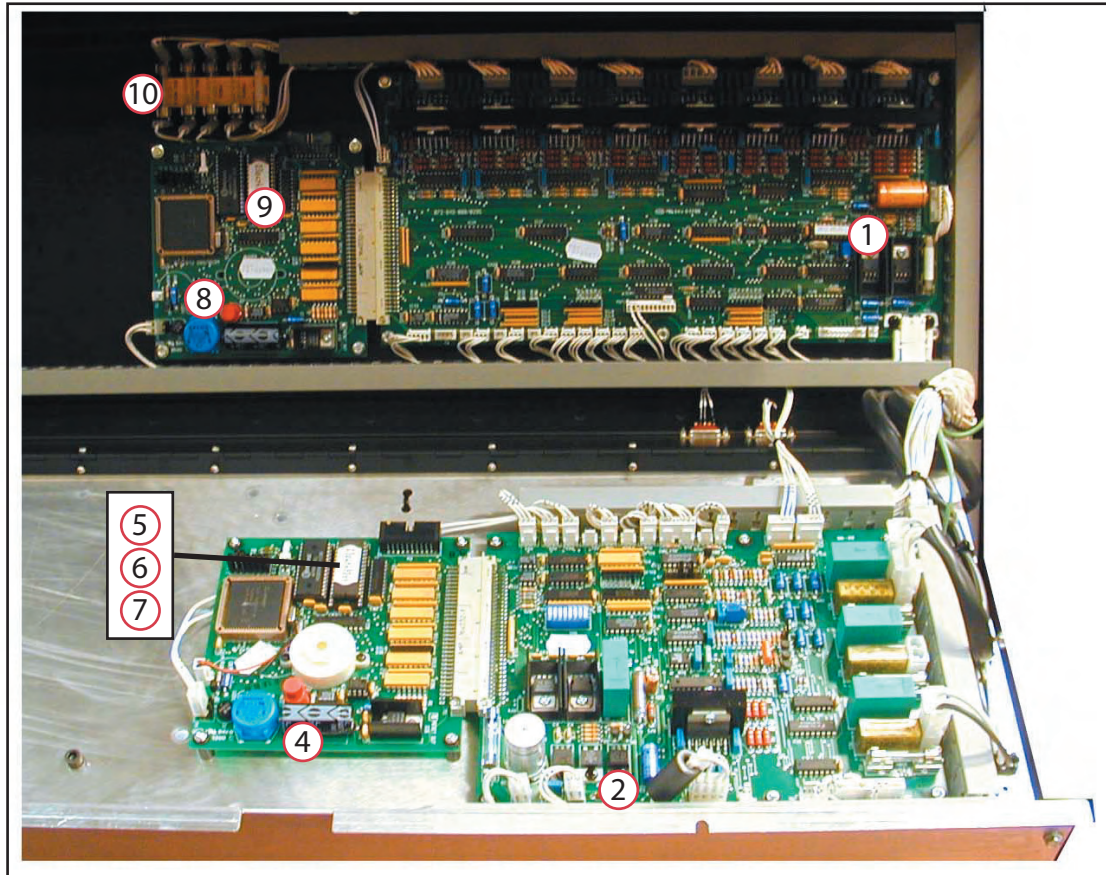

<i>Pos.</i>	<i>Part No.</i>	<i>Designation</i>	<i>Notes</i>	<i>C</i>
01	296-705-000	Loader interface board		
02	296-704-000	Developer interface board		
04	296-711-000	Developer CPU board without E-PROM		
05	212-774-000	Processor E-Prom for Type I processor		
06	200261	Loader and processor E-Prom kit Type II	Read TI 53	
07	200261	Loader and processor E-Prom kit Type III	Read TI 53	
08	296-701-000	Loader CPU without E-PROM		
10	412-475-000	Fuse holder (10 pieces) use only 5		C
11	414-061-000	Solid state relay 25A Developer Dryer/Heater		
12	064-950-000	RC-filter for solid state relay		
13	414-071-000	Solid state relay 25A Developer Vacuum fan		
14	412-443-000	Fuse holder		C
15	412-428-000	Cap for fuse holder		C
16	412-475-000	Fuse holder (10 pieces)		C
17	415-079-000	Capacitor 10000µf 40V		
18	416-408-000	Bridge rectifier		
19	414-975-000	Line noise filter 250V/3A		
20	414-254-000	Transformer		
	412-242-000	Terminal strip 8 pol.		
	412-448-000	Fuse 0,6A Slow		C
	412-440-000	Fuse 1A Slow		C
	412-474-000	Fuse 3A Slow		C



Electronics (2)

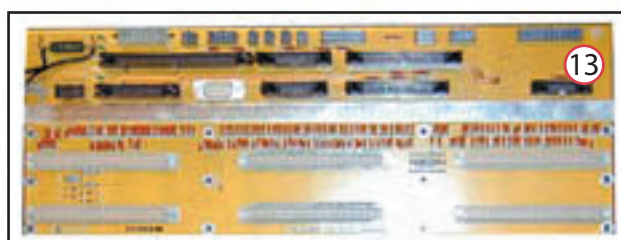
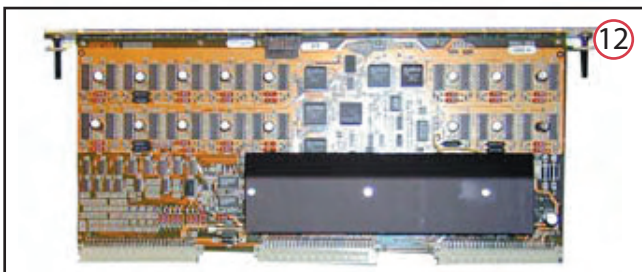
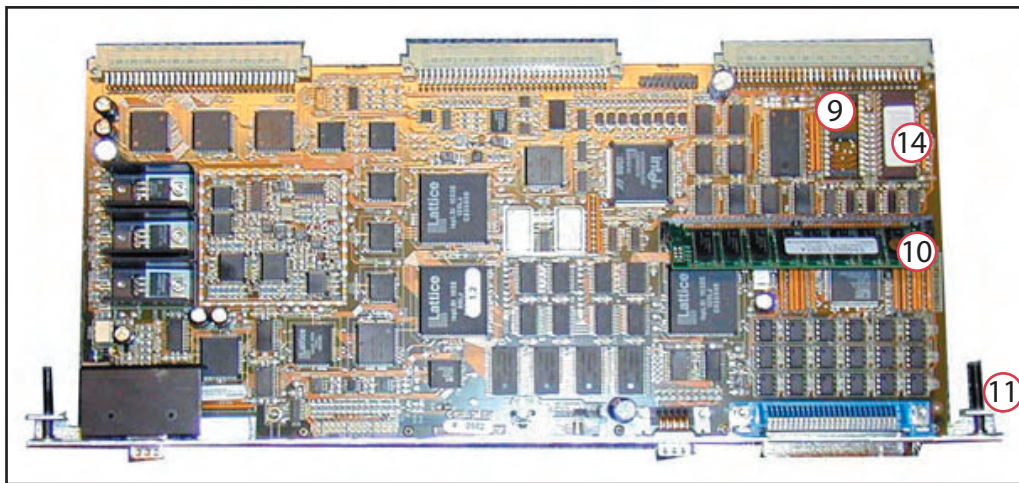
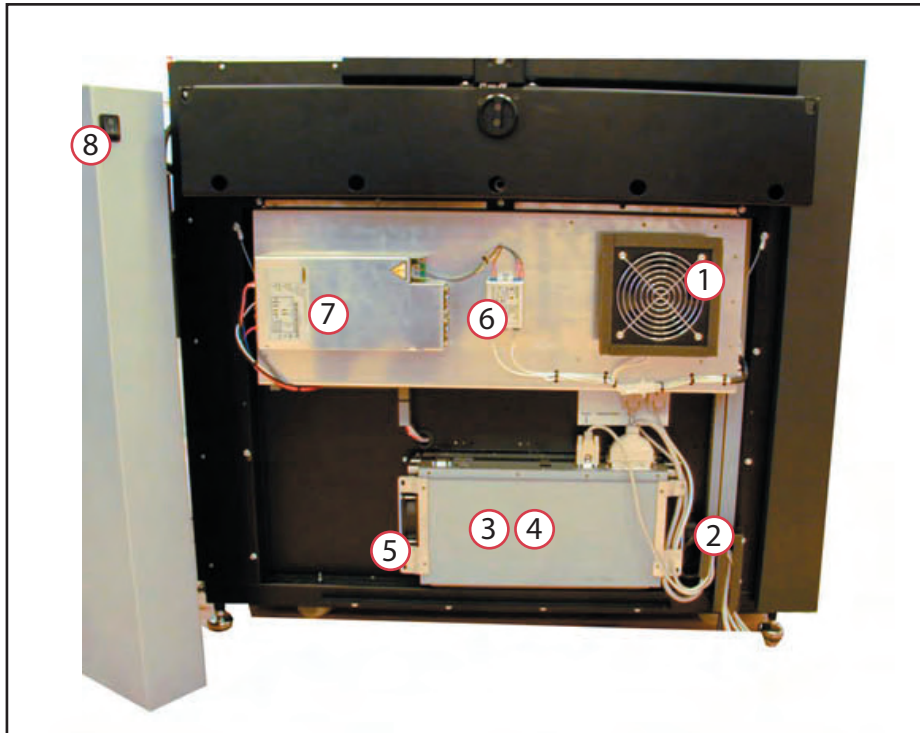

<b>Pos.</b>	<b>Part No.</b>	<b>Designation</b>	<b>Notes</b>	<b>C</b>
01	067-090-000	Main fan		
02	411-545-000	Mains plug		
03	219-611-000 S	Complete "flying spot box" 20K spinner	Read TI. 41	
04	219-611-000 S	Complete "flying spot box" 30K spinner		
05	9604000220	Electronics cooling fan		
06	414-970-000	Mains filter		
07	6504450010	Power supply	Repl. 212-823-000S	
08	411-172-000	On/Off swich		
09	9604450170	NV-RAM		
10	9605501230	Ram module, DRAM 16MB 60ns		
11	9605501220 S	Control board without NV-RAM		
12	9604300010 S	Driverboard suitable for 20 and 30K spinners		
13	9604000030	Backplane		
14	400553	Bootprom Ver. F		
	9604500691	Small coax cable for laser	(Not shown)	
	213-049-000	Upgrade kit old style PSU to New PSU	Read TI. 37	

### Chassis

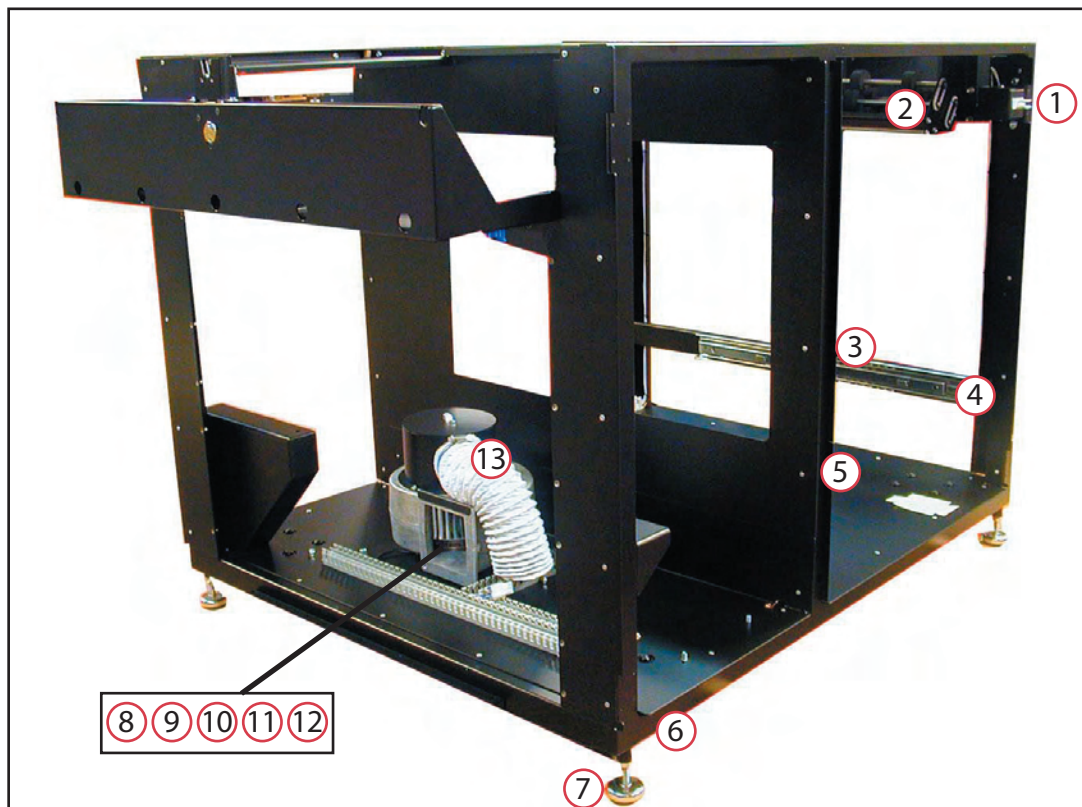

<b>Pos.</b>	<b>Part No.</b>	<b>Designation</b>	<b>Notes</b>	<b>C</b>
01	411-145-000	Interlock switch		
02	035-087-000	Spring for kicker section		C
03	048-213-003	Lock for processor		
04	043-368-000	Processor rail right		
05	043-369-000	Processor rail left		
06	459-714-000	Wheel		
07	459-806-000	Stand		
08	213-083-000	Vacuum fan complete and adjusted (M9)	Read TI. 55	
	089-361-000	Vacuum motor (M9)		
09	459-541-000	Vibration absorbers for vacuum fan		
10	032-558-000	Encoder label for vacuum fan	Read TI. 55	
11	296-708-000	Vacuum reflex sensor		
12	048-910-003	Bracket for Vacuum reflex sensor		
13	403-493-000	Vacuum hose		
14	411-145-000	Interlock switch		
15	011-371-000	Foam roller		C
16	079-028-000	Kick motor (M10)		
17	048-982-000	Air filter for Processor		C
18	079-144-000	Buffer guide complete		



## Panels

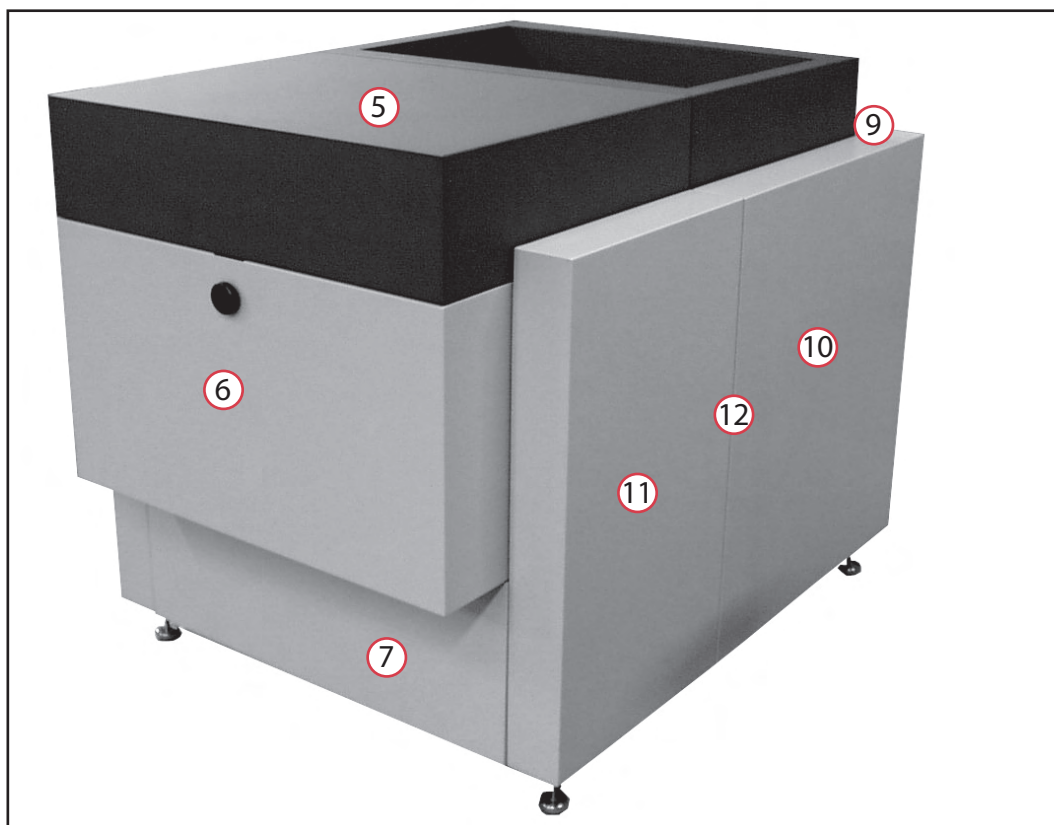



<i>Pos.</i>	<i>Part No.</i>	<i>Designation</i>	<i>Notes</i>	<i>C</i>
01	079-112-XXX	Top panel		
	014-015-360	New top panel	Fr. ser.#44411288	
02	411-172-000	Switch, main power		
03	079-106-XXX	Right panel, back		
	014-014-361	New Right panel, back	Fr. ser.#44411288	
04	079-105-XXX	Left panel, back		
	014-011-361	New Left panel, back	Fr. ser.#44411288	
05	079-113-XXX	Top lid		
	300717	New Top lid	Fr. ser.#44411288	
	459-713-000	Gas piston.		
06	079-108-XXX	Left panel, top		
	500746	New Left panel, top	Fr. ser.#44411288	
07	079-107-XXX	Left panel, bottom		
	014-012-361	New Left panel, bottom	Fr. ser.#44411288	
08	031-317-000	Lid lock button.		
09	079-109-XXX	Right panel.		
	014-013-361	New Right panel	Fr. ser.#44411288	
10	079-111-XXX	Right door.		
	501561	New Right door	Fr. ser.#44411288	
11	079-110-XXX	Left door		
	501562	New Left door	Fr. ser.#44411288	
12	079-115-000	Locking mechanism complete	"old" type doors	
	1619027	Locking mechanism	"new" type doors	
	602274	Gas damper for "new" style top cover	Fr. ser.#44411288	
	405-400-801	Paint, White		

**Colour codes**

XXX-XXX-100 Above panel painted in white/grey  
 XXX-XXX-200 Above panel painted in silver/black  
 XXX-XXX-700 Above panel painted in white (OEM)

Type I Processor (1)

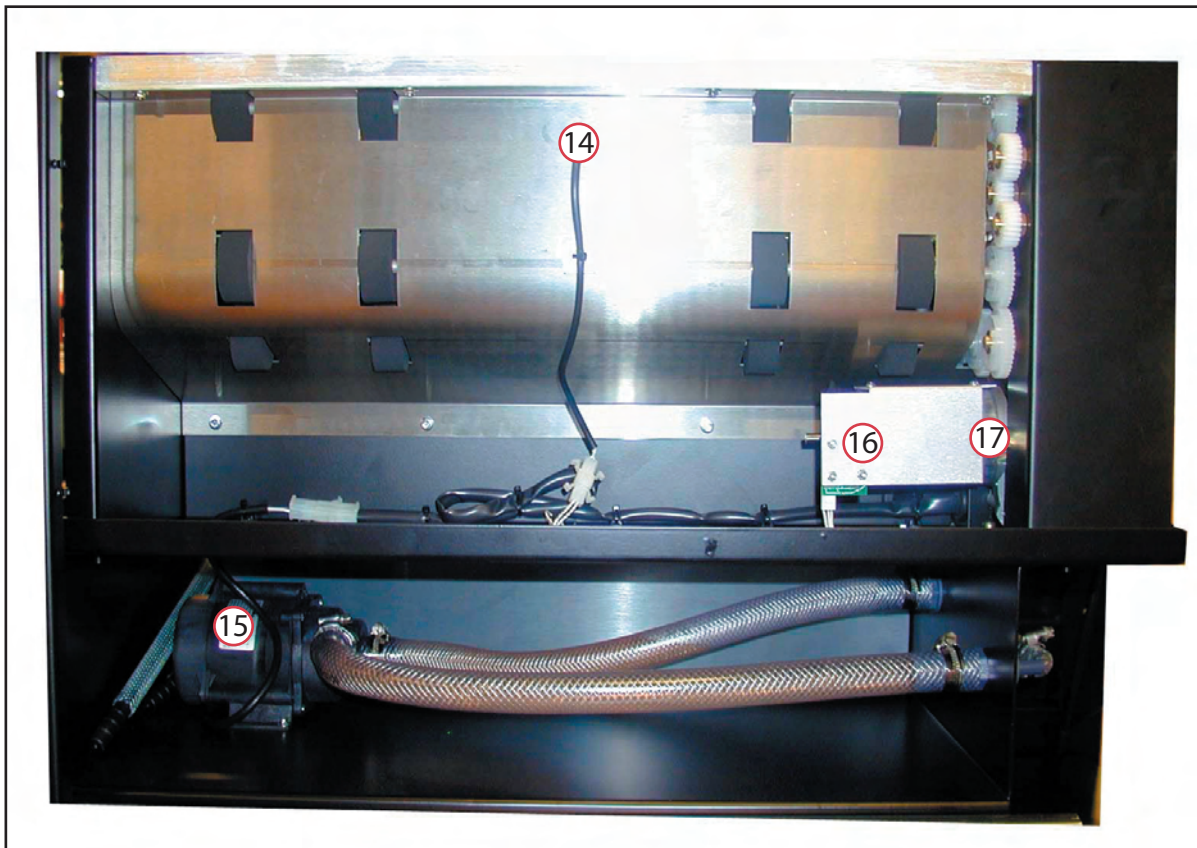
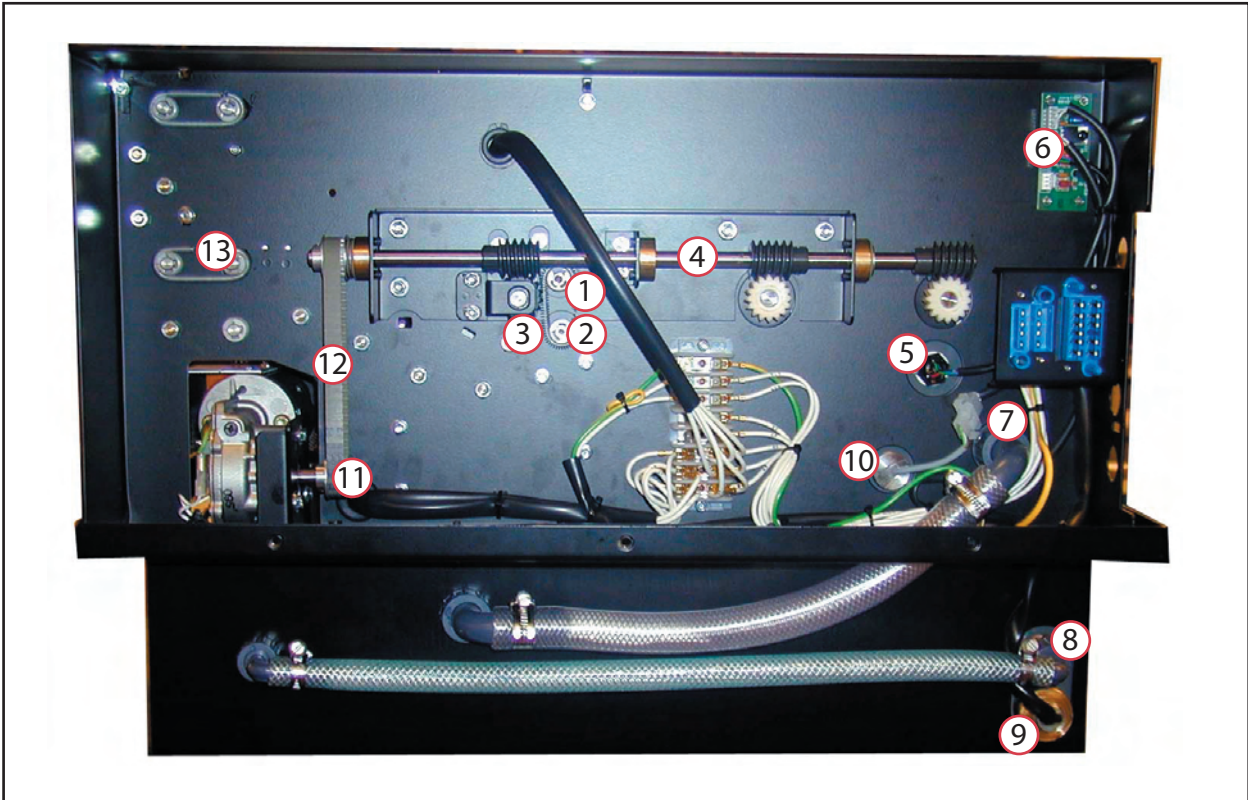

<b>Pos.</b>	<b>Part No.</b>	<b>Designation</b>	<b>Notes</b>	<b>C</b>
01	022-614-013	Top roller, dryer.		C
02	022-652-000	Main drive roller, dryer.		C
	212-771-000	Gear w. bearing, free run.		
03	035-087-000	Spring, hard.		C
04	079-026-000	Drive shaft, assy.		
05	066-923-000	Level sensor.		
06	296-774-000	Interface for liquid level.		
07	459-791-000	Threaded hose, cou. 3/4"		
08	459-792-000	Threaded hose, cou. 1/2"		
	450-349-000	Gasket.		
09	067-379-000	Heating element, 700w.		
10	262-328-000	Temperature sensor.		
11	030-946-000	Pulley.		
12	452-091-000	Belt.		
13	035-046-000	Spring, soft.		C
14	021-345-000	Sensor heat, compl.		
15	066-102-000	Circulation pump, developer.		
16	296-599-000	Limit switch.		
17	413-055-000	Main motor.		
	082-168-000	Heater / blower, compl.		
	067-534-000	Service cable, Developer /dryer unit to main unit		

Type I Processor (2)



<b>Pos.</b>	<b>Part No.</b>	<b>Designation</b>	<b>Notes</b>	<b>C</b>
01	211-781-000 211-006-000	Activator bottle compl. Stabilizer bottle compl.		



**Type I Activator rack (3)**

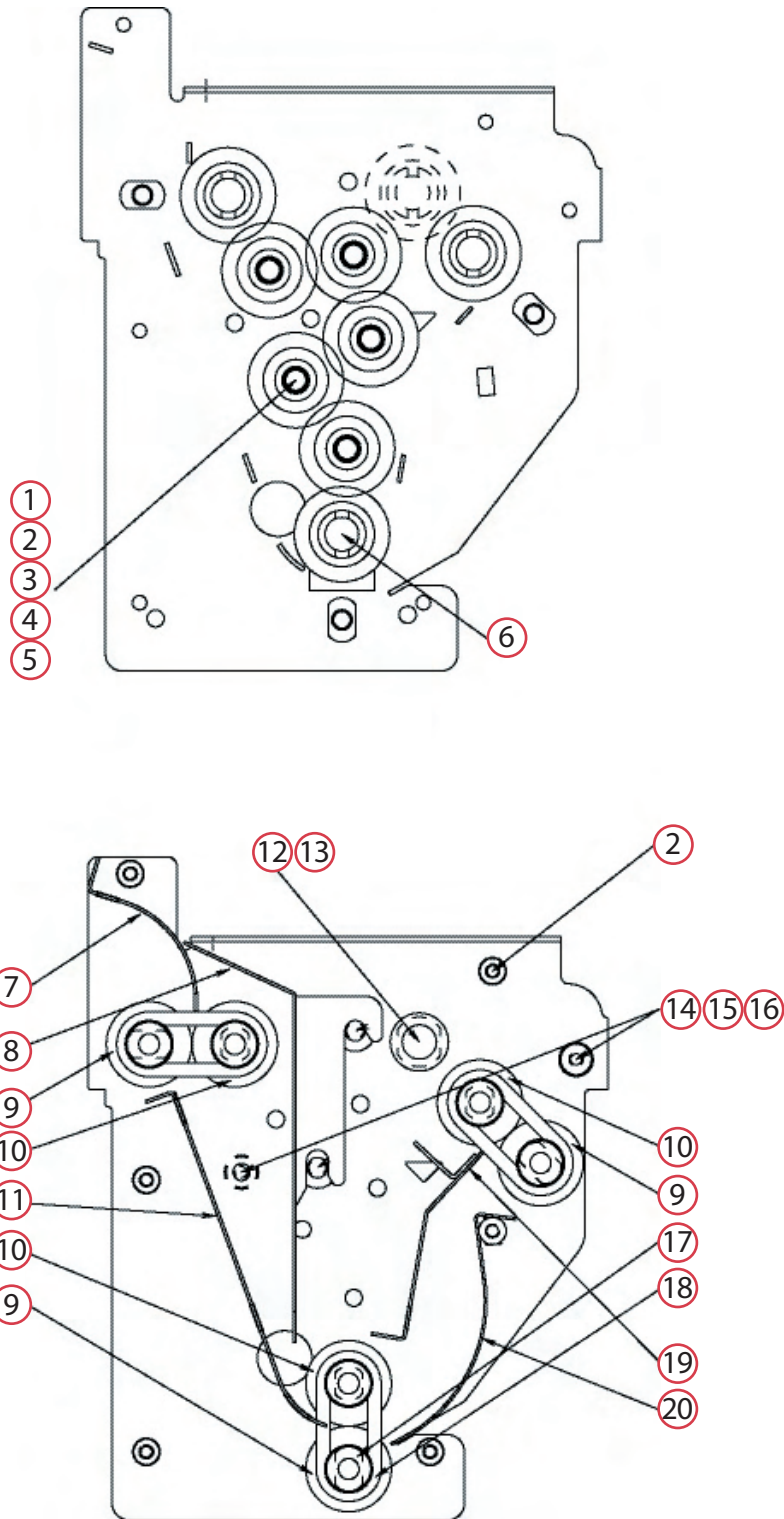

<i>Pos.</i>	<i>Part No.</i>	<i>Designation</i>	<i>Notes</i>	<i>C</i>
	<b>200-986-000</b>	<b>Activator rack, complete</b>		
01	055-472-000	Pin bearing		
02	469-406-000	Washer star 4,2		
03	030-152-000	Gear 16 T		
04	056-121-000	Washer 0,8X12X0,4		
05	470-704-000	Ring, retaining rs7		
06	222-638-000	Roller rubber Assy		C
07	048-945-033	Guide A		
08	048-946-033	Guide B		
09	022-616-000	Roller A		C
10	222-638-000	Rubber roller assy		C
11	049-193-033	Guide C		
12	254-075-000	Drive shaft Z17 3MR Assy		
13	055-388-000	Bearing Ø10,03		C
14	057-252-000	Spacer		
15	462-293-000	Screw M4X8		
16	600625	Washer stainless	Repl. 468-405-000	
17	081-972-000	Bearing for rubber roller		
18	035-182-000	Spring		C
19	048-949-033	Guide E		
20	049-447-000	Guide D		
	049-447-000	FRm Rack kit	Read TI. 46	

**Type I Stabilizer rack (4)**

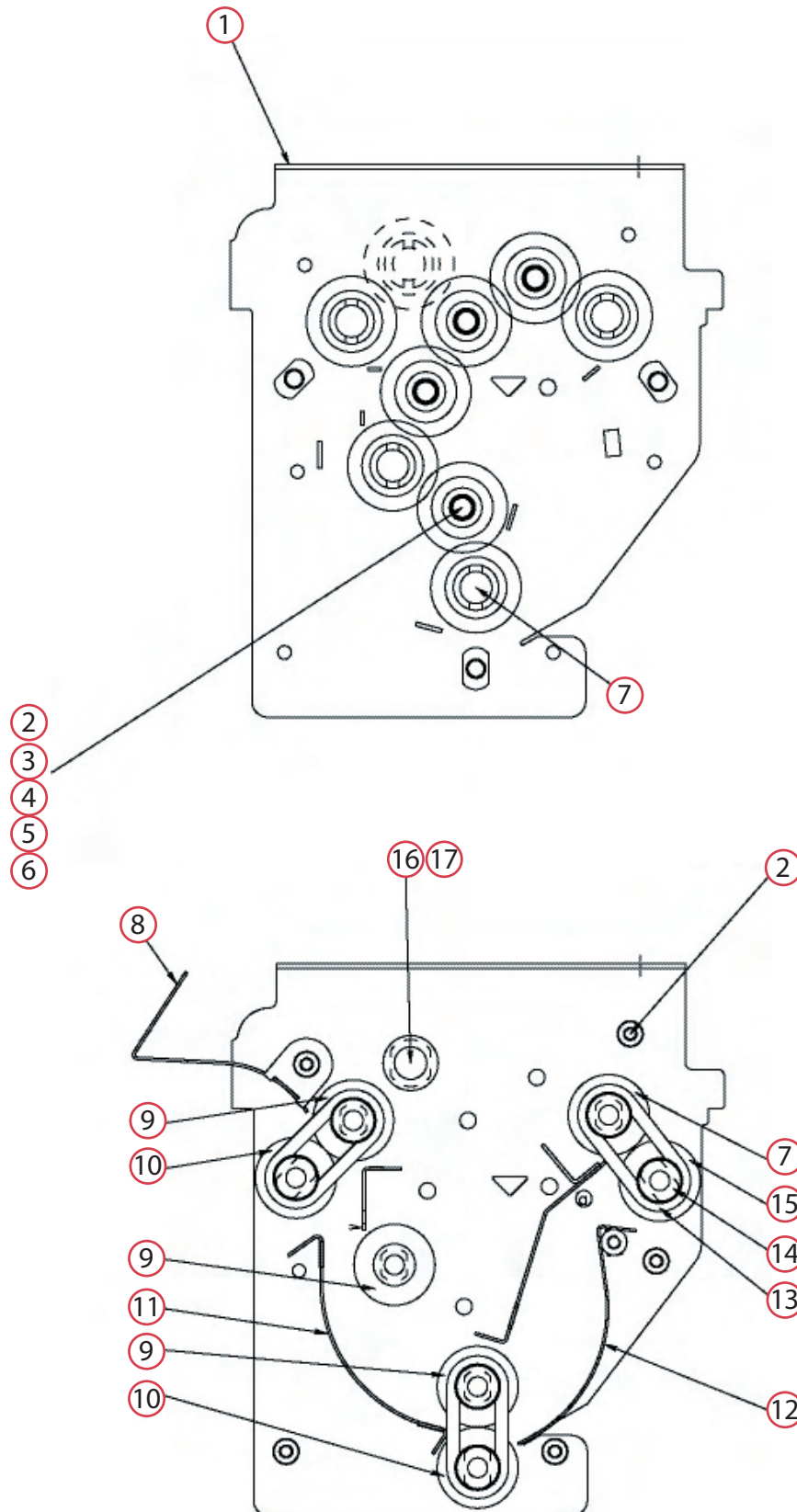

<i>Pos.</i>	<i>Part No.</i>	<i>Designation</i>	<i>Notes</i>	<i>C</i>
	<b>212-816-000</b>	<b>Stabilizer rack complete</b>		
01	049-299-033	Act. rack end plate		
02	469-406-000	Washer star 4,2		
03	462-293-000	Screw M4X8		
04	030-152-000	Gear 16 T		
05	056-121-000	Washer 0,8X12X0,4		
06	470-704-000	Ring, retaining rs7		
07	222-638-000	Roller Assy. Consists of:		C
	022-616-000	Roller A		C
	030-153-000	Gear 16 T		
08	049-030-033	Guide F		
09	222-638-000	Rubber roller assy		C
10	022-616-000	Roller A		C
11	049-032-033	Guide H		
12	049-447-000	Guide D		
13	035-182-000	Spring		C
14	081-972-000	Bearing Assy. Consists of:		
	055-222-000	Bushing		C
	059-988-000	Support spring		
15	022-616-000	Roller A		C
16	055-388-000	Bearing Ø10,03		C
17	254-075-000	Driveshaft Assy. Consists of:		
	030-151-000	Gear 16T		
	230-014-000	Drive gear rack	Repl. 030-356-000	C
	035-401-000	Spring for rack		C
	053-052-000	Driveshaft		
	056-265-000	Washer for spring		
	466-306-000	Pin 3x16		
	470-915-000	Retaining ring		
	049-447-000	FRm Rack kit	Read TI 46	



Type II Processor (1)

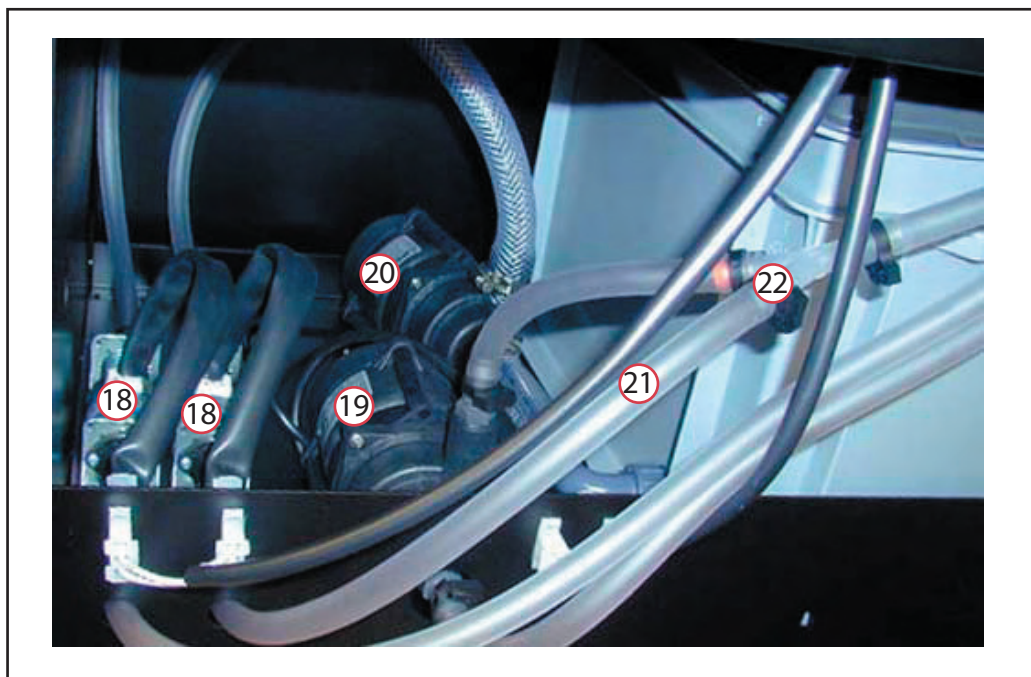



<b>Pos.</b>	<b>Part No.</b>	<b>Designation</b>	<b>Notes</b>	<b>C</b>
01	413-917-000	Motor 24V		
02	049-377-003	Drive shaft assembly		
03	053-091-000	Shaft/worm wheels, dryer/stabilizer/activator		C
04	230-017-000	Worm right	Repl. 030-098-000	C
05	030-099-000	Worm left		C
06	057-139-000	Bearing housing		
07	451-021-000	Needle bearing		C
08	030-945-000	Pulley main drive		
09	048-113-003	Bracket		
10	030-355-045	Worm wheel right		C
11	030-963-000	Gear M1 Z25		
12	296-774-000	Interface board		
13	458-019-000	Hose connection		
14	419-304-000	Level sensor		
15	013-858-000	Lid for waste container		
16	013-857-000	Waste container		
17	067-288-000	Waste container level sensor		
	452-141-000	Processor drive belt		
18	067-007-000	Replenishment pump		
19	067-794-000	Circulation pump		
20	066-102-000	Pump for waste		
21	403-371-000	Hose, order in metres		
22	459-825-000	Hose clamp		

Type II Processor (2)



<i>Pos.</i>	<i>Part No.</i>	<i>Designation</i>	<i>Notes</i>	<i>C</i>
01	035-087-000	Spring hard Z17 3MR		C
02	411-154-000	Switch operate test		
03	021-345-000	Sensor temp. dryer comp.		
04	458-022-000	Replenisher container w/lid		
05	450-408-000	Hose connection female		
06	450-411-000	Hose connection female replenishment		
07	450-409-000	Hose connection male		
08	049-341-000	Lid for processor		
	450-407-000	Hose for waste	(Not shown)	

Type II Processor (3)

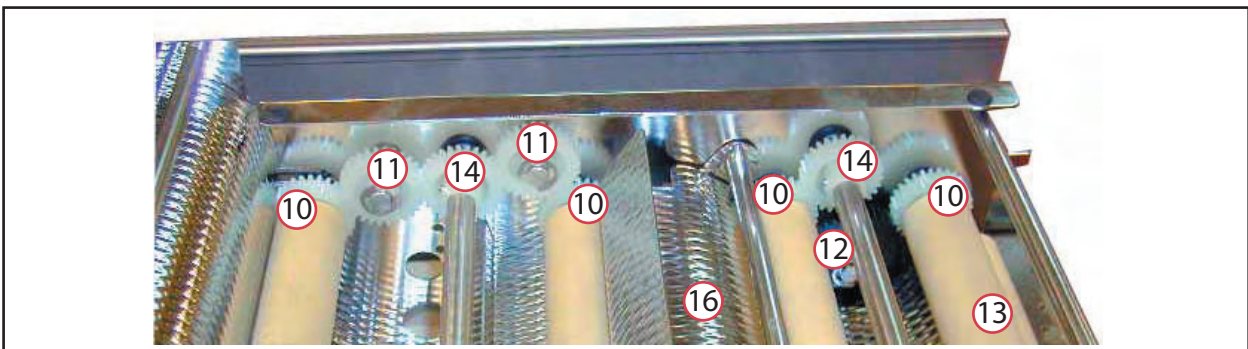
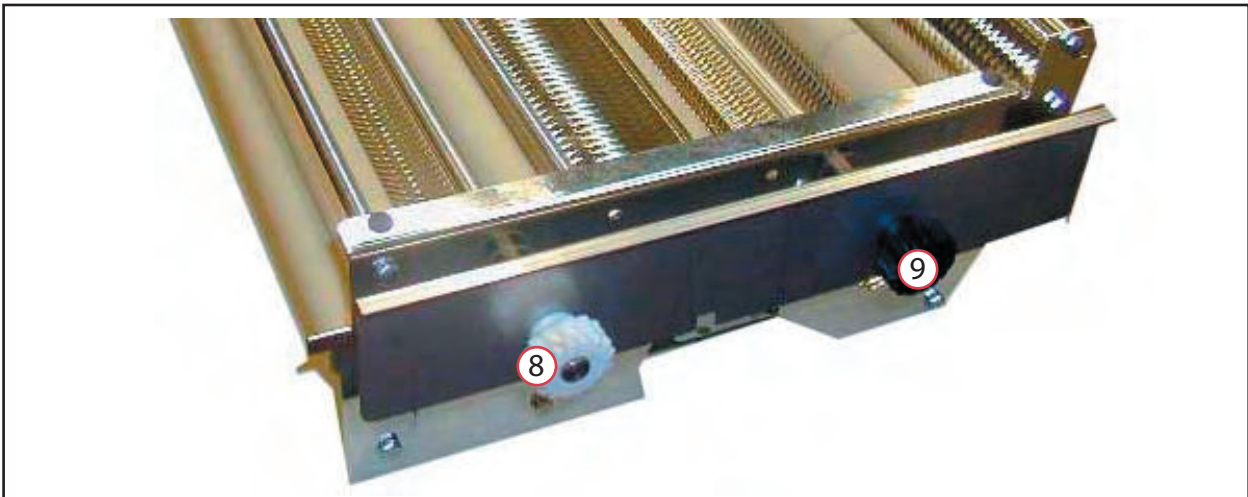
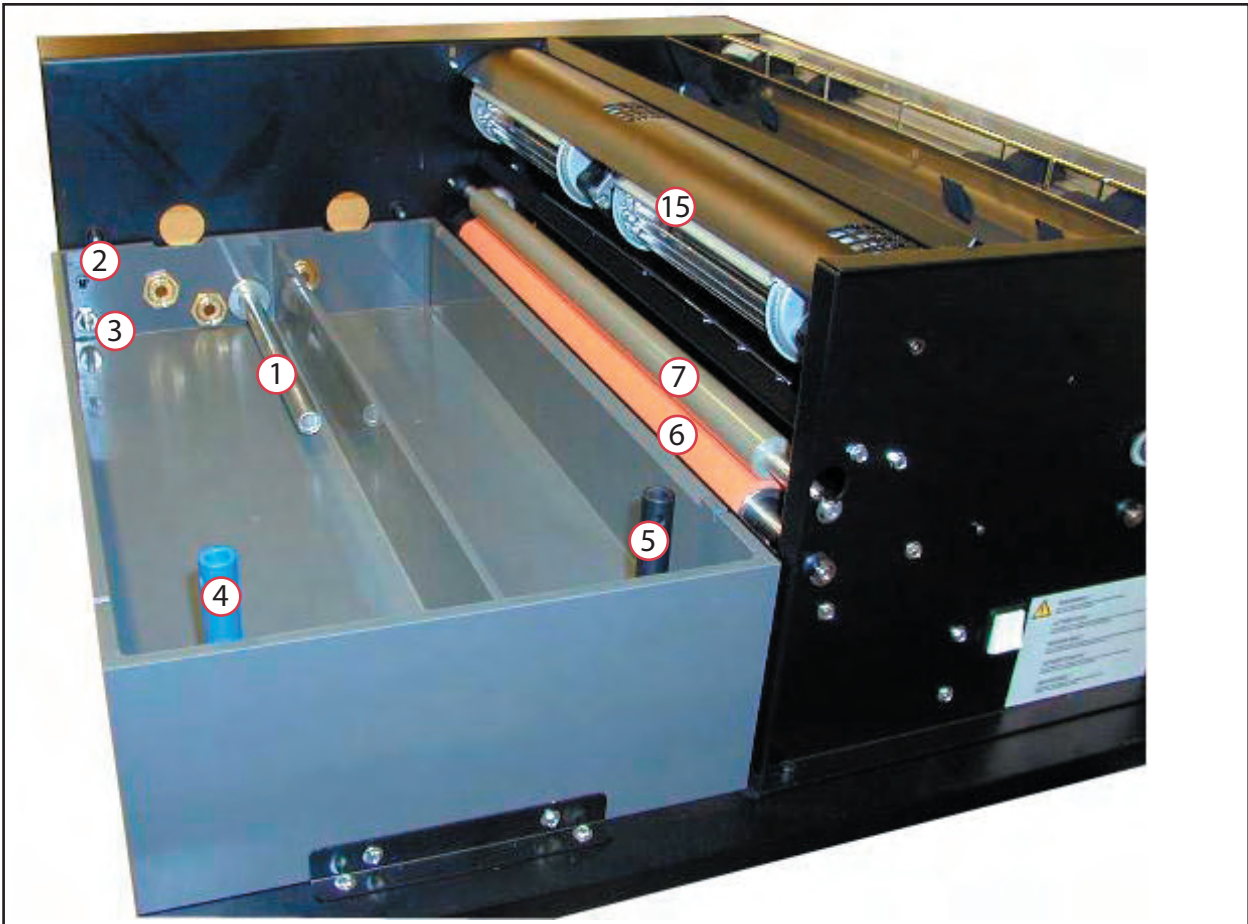

<i>Pos.</i>	<i>Part No.</i>	<i>Designation</i>	<i>Notes</i>	<i>C</i>
01	067-060-000	Heating element 300W		
02	066-923-000	Liquid level sensor		
03	057-812-000	Thermosensor housing		
04	013-761-000	Overflow/draining tube blue activator		
05	013-930-000	Overflow/draining tube black stabiliser		
	459-638-000	O-Ring overflow tube		C
06	022-652-000	Rubber roller, compl.		C
07	022-676-013	Teflon roller		C
08	230-014-000	Drive gear, rack	Repl. 030-356-000	C
09	030-355-045	Worm wheel, right		C
10	018-035-000	Gear, roller		
11	018-037-000	Gear		
12	030-137-000	Gear, black		
13	022-675-000	Roller, rubber		C
14	018-036-000	Gear		
15	082-168-000	Heater/blower		
	240-281-000	Type II rack without modifications		
	213-058-000	Type II modification kit		
	240-284-000	Type II Rack for modified type II processor		C
16	049-330-033	Crossover guide		



Type III Processor (1)

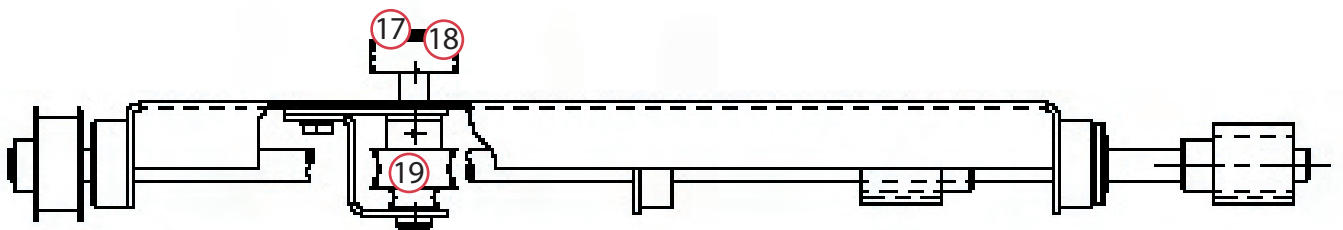
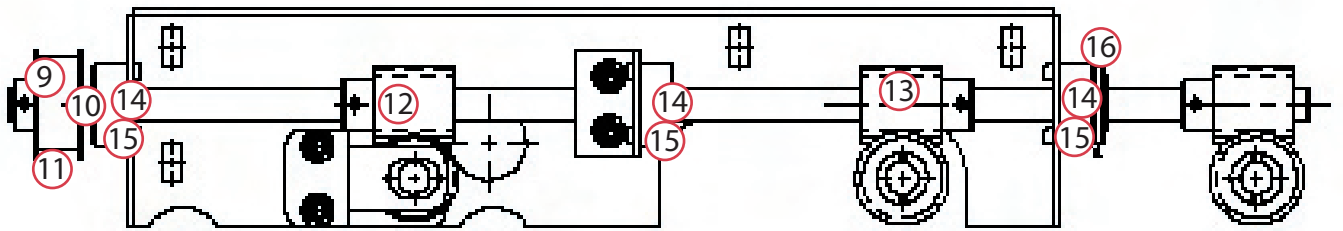
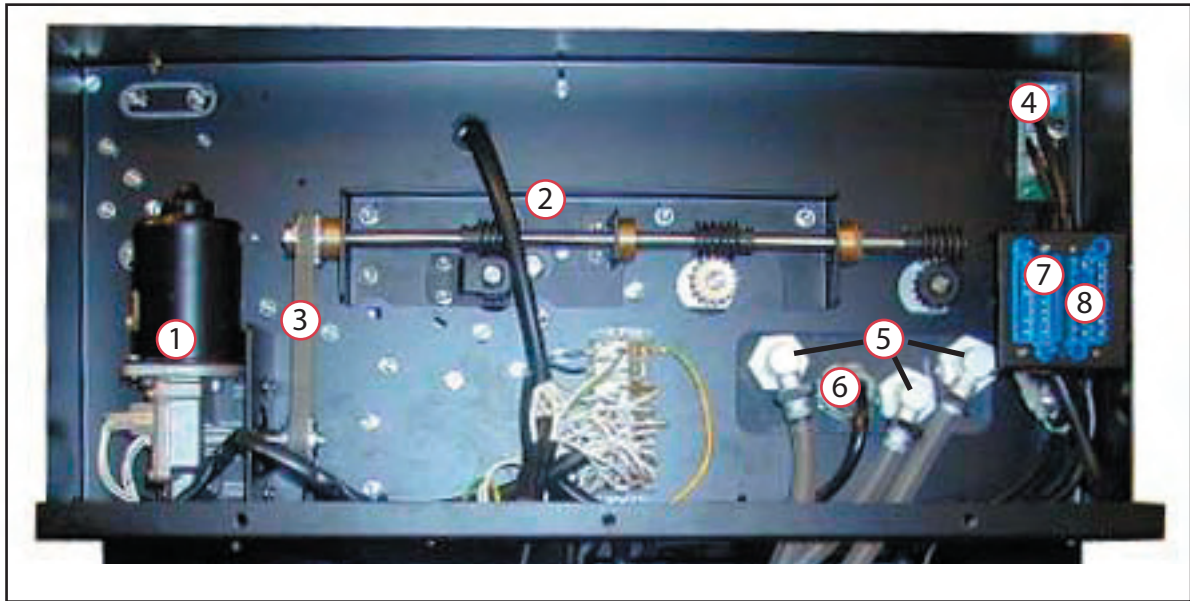

<b>Pos.</b>	<b>Part No.</b>	<b>Designation</b>	<b>Notes</b>	<b>C</b>
01	413-917-000	Processor maindrive motor		
02	049-351-000	Drive shaft assembly		
03	452-141-000	Processor drive belt		
04	296-774-000	Interface board		
05	458-019-000	Hose connection		
06	067-060-000	Activator heating element 300W		
07	413-684-000	Blue plug for processor Male		
08	413-685-000	Blue plug for processor Female		
09	018-059-000	Pulley	Repl. 018-059-090	
10	451-016-013	Teflon washer		
11	018-059-000	Pulley	Repl. 018-059-090	
12	230-017-000	Worm gear right	Repl. 030-098-000	C
13	030-099-000	Worm gear Left		C
14	057-139-000	Housing for bearing	Repl. 057-139-080	
15	451-021-000	Bearing		C
16	470-915-000	C-Clip		
17	470-704-000	C-Clip		
18	030-963-000	Gear M1 Z25	Repl. 030-963-080	
19	030-355-045	Worm gear right	Repl. 030-355-090	C

Type III Processor (2)

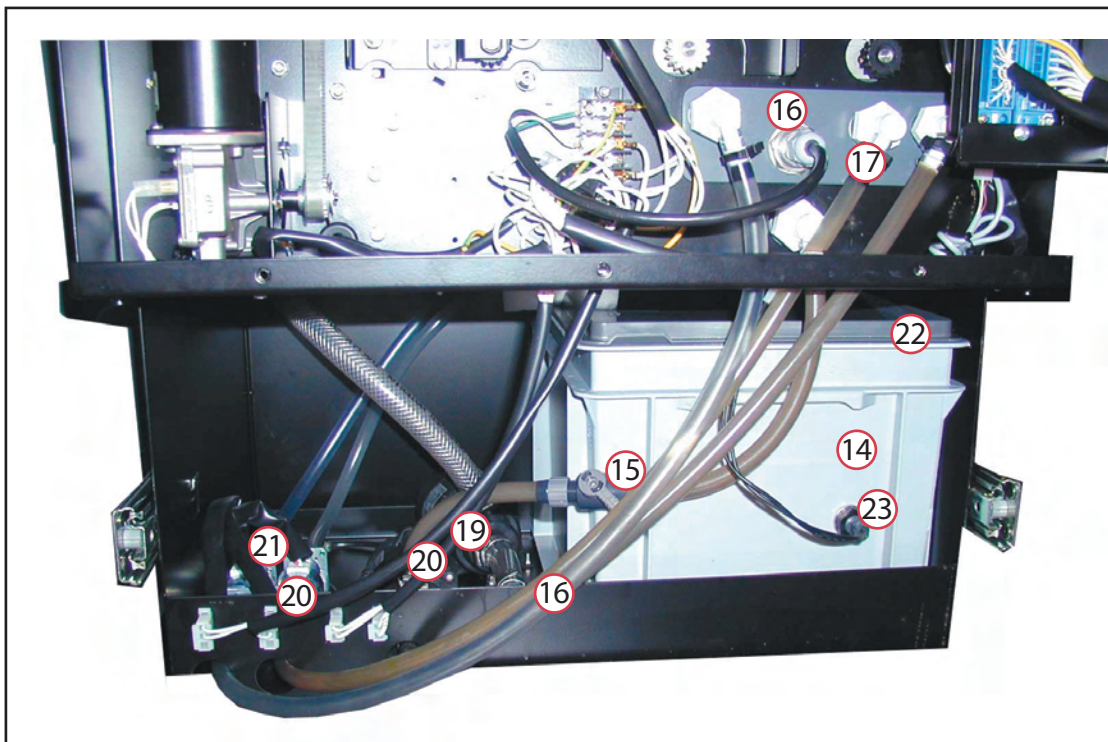
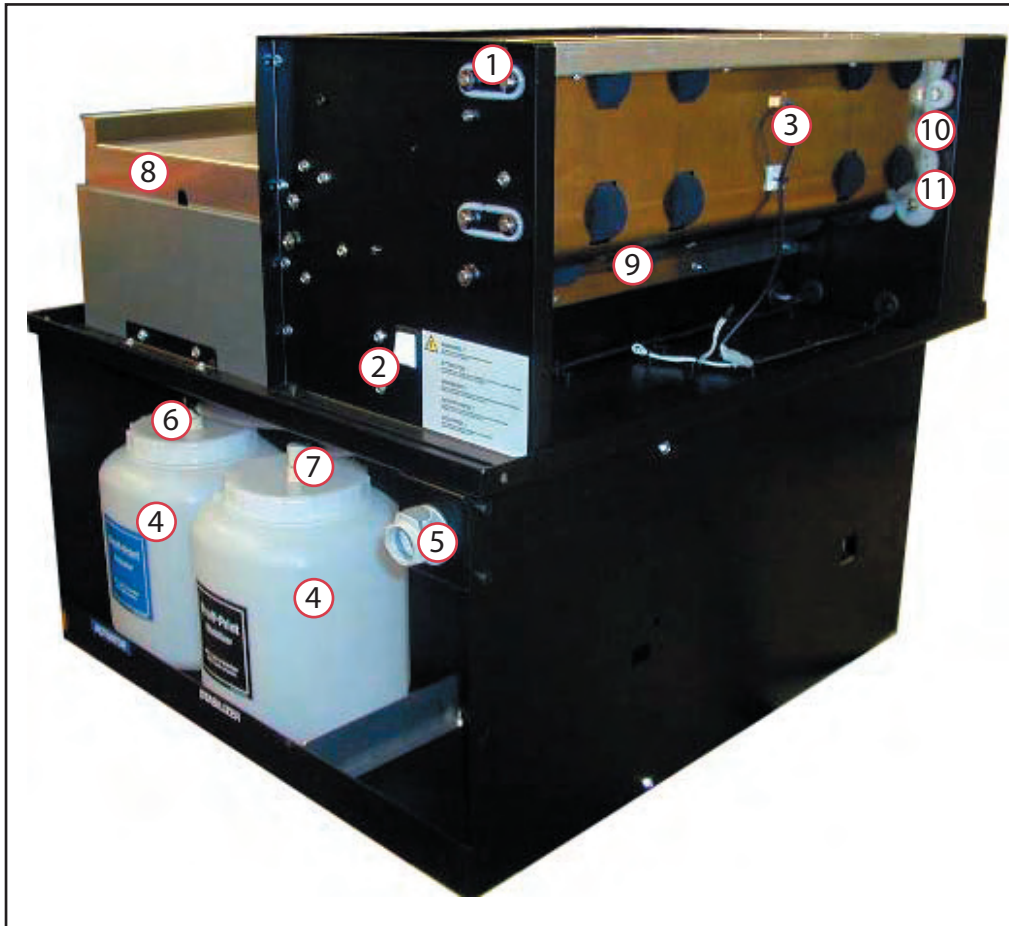

<b>Pos.</b>	<b>Part No.</b>	<b>Designation</b>	<b>Notes</b>	<b>C</b>
01	035-087-000	Spring hard Z17 3MR		C
02	411-154-000	Switch operate test, for waste pump		
03	021-345-000	Sensor temp. dryer comp.		
04	458-022-000	Replenisher container w/lid		
05	450-408-000	Hose connection female		
06	450-411-000	Hose connection female activator		
07	450-409-000	Hose connection male stabilizer		
08	049-341-000	Lid for processor		
09	011-371-000	Foam roller 1pc.		C
10	030-963-000	Gear Z25		
11	030-426-000	Gear 40Z		
	450-407-000	Hose for waste tank		
	300169	Kicker kit	Read TI 47a	
12	067-060-000	Activator heating element 300W		
13	459-825-000	Hose clamp		
14	013-857-000	Waste tank		
15	450-418-000	Valve for circularization		
16	403-371-000	Hose (order in meters)		
17	048-982-000	Air filter for processor (Not shown)		C
18	067-090-000	Fan for processor (Not shown)		
19	066-102-000	Waste pump		
20	067-794-000	Circulation pump		
21	067-007-000	Replenish pump		
22	013-858-000	Lid for waste tank		
23	067-288-000	Waste tank full sensor		
	452-141-000	Processor drive belt		



Type III Processor (3)

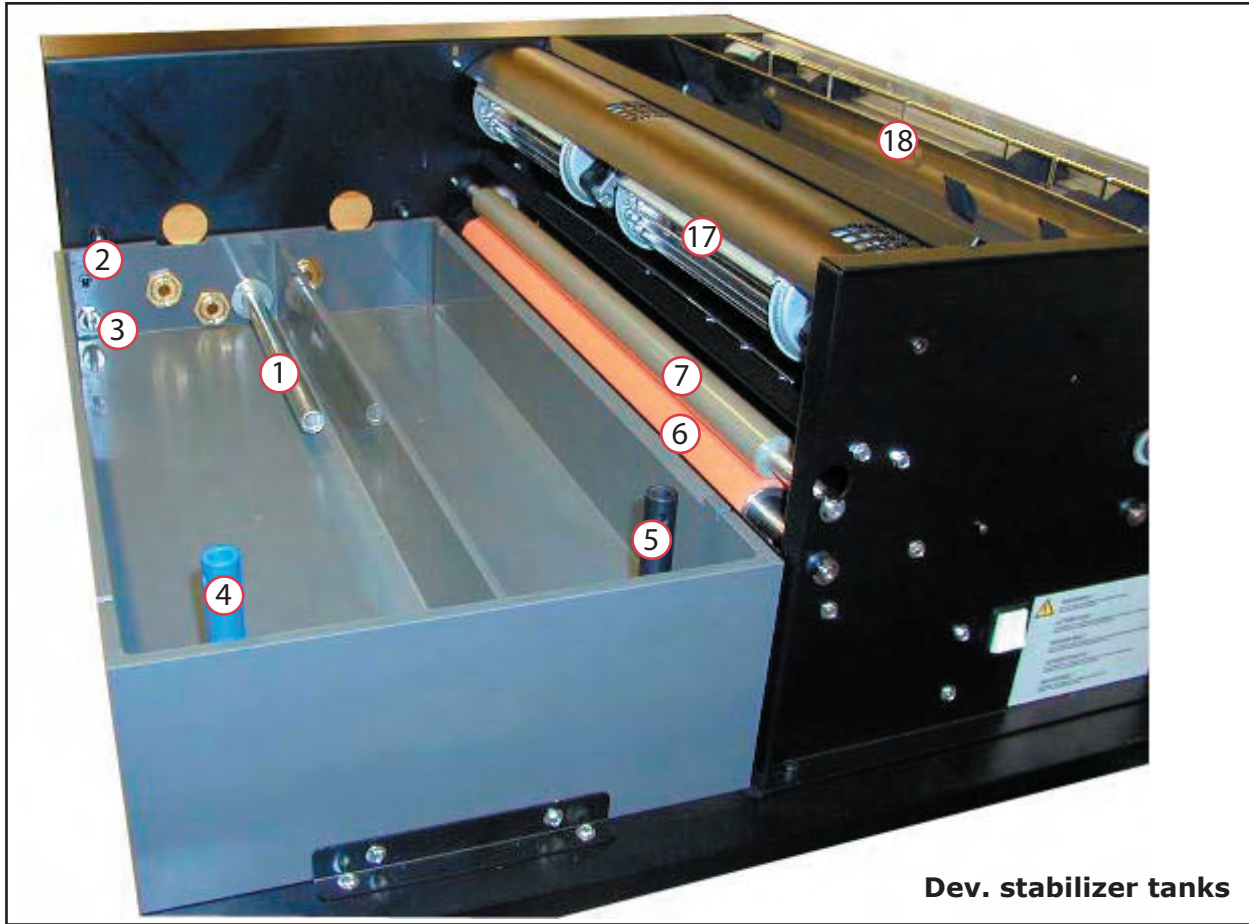

Dev. stabilizer tanks

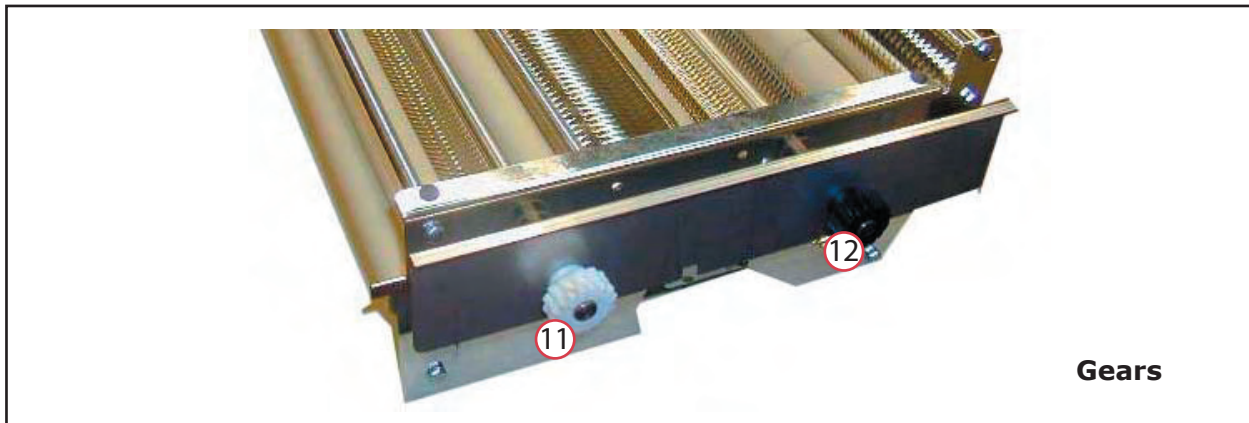

Gears

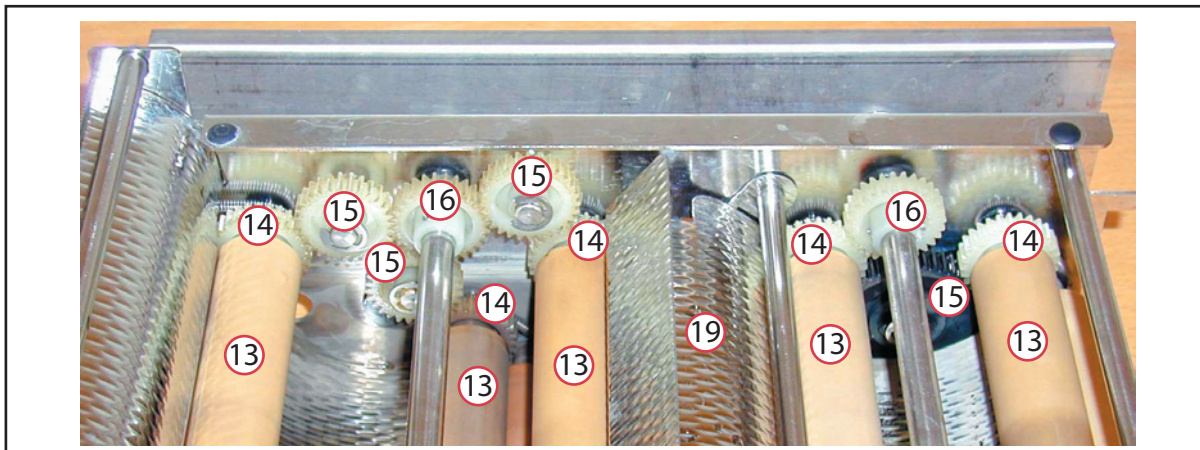

Rack



<i>Pos.</i>	<i>Part No.</i>	<i>Designation</i>	<i>Notes</i>	<i>C</i>
01	067-060-000	Activator heating element 300W		
02	066-923-000	Liquid level sensor		
03	057-812-000	Thermosensor housing		
04	013-761-000	Overflow/draining tube blue activator		
05	013-930-000	Overflow/draining tube black stabiliser		
	459-638-000	O-ring for Overflow/draining tube		C
06	022-652-000	Squeezee roller rubber		C
07	022-676-013	Squeezee roller teflon		C
11	230-014-000	Stabilizer drive gear	Repl. 030-356-000	C
12	030-355-045	Activator drive gear		C
13	022-675-000	Rubber roller complete		C
14	018-035-000	Gear		
15	018-037-000	Gear 48T		
16	018-036-000	Gear		
17	082-168-000	Heater/blower		
18	049-029-033	Fixed Guide		
	049-024-033	Removable wire guide	Repl. 049-024-000	
	240-284-000	Type III rack		C
	300019	Fan Kit for processor compartment	Read TI. 45	
19	049-330-033	Crossover guide		

Part No.	Designation	Notes	C
<b>RECOMMENDED SPARE PARTS KIT</b>			
<del>200-932-000</del>	<del>Kit</del>	<del>P/N removed</del>	
011-948-000	Fitting Ø19 for punch hose		
018-008-000	Gear Z11		
021-345-000	Sensor, heat, comp.		
022-616-000	Roller		C
022-675-000	Rubber Roller		C
030-151-000	Gear Z16		
030-426-000	Gear Z40		
030-963-000	Gear Z25		
030-982-000	Gear Z40		
066-102-000	Circ.pump		
066-923-000	Liquid level sensor		
067-049-000	Motor, step		
067-051-000	Motor, DC		
067-060-000	Heating element, 300W.		
067-288-000	Float switch.		
067-794-000	Circulation pump, Ø 10 mm.		
082-168-000	2 X 400W Heater blower		
089-361-000	Vacuum motor w/encoder, label	Repl. 079-117-000	
9604400020S	Spinner motor w/mirror	Repl. 9604500090S	
213-049-000	Power supply, flying spot box	Repl. 212-823-000	
219-611-000S	Flying spot box, 30.000 rpm		
222-638-000	Rubber roller, compl.		C
262-328-000	Temp.sensor		
296-734-000	Reflex sensor	Repl. 296-598-000	
296-599-000	Limit switch board		
296-701-000	Loader CPU board without E-PROM		
296-704-000	Dev. interface board		
296-705-000	Loader interface board		
296-708-000	Vacuum reflex sensor		
296-723-000	Reflex sensor slimline ver.2		
296-774-000	Interface for liquid level		
405-110-000	Grease for processor		
411-145-000	Interlock		
411-160-000	Microswitch		

<b>Pos.</b>	<b>Part No.</b>	<b>Designation</b>	<b>Notes</b>	<b>C</b>
	412-428-000	Cap for fuse		C
	412-440-000	Fuse 1A		C
	412-446-000	Fuse 3A		
	412-448-000	Fuse 0,6A		C
	412-451-000	Fuse 15A		
	412-452-000	Fuse 1,6A		
	412-462-000	Fuse 10A		
	412-466-000	Fuse 8A		
	412-469-000	Fuse 0,3A		
	412-471-000	Fuse 4A FF		
	412-474-000	Fuse 3A		C
	412-476-000	Fuse 100 mA		
	412-868-000	Jumper		
	413-075-000	Motor 24V DC, 75RPM 1 NM		
	413-081-000	Motor, 24 VDC 0,018 NM		
	413-917-000	Motor w. encoder.		
	414-061-000	Solid state relay		
	414-071-000	Solid state relay		
	415-079-000	Capacitor 10000 $\mu$ F 40V		
	415-180-000	Capacitor 6 $\mu$ F	Repl. 5 $\mu$ F 400V	
	416-408-000	Rectifier bridge		
	419-240-000	Microswitch w/dial		
	419-241-000	Microswitch w/slide		
	419-243-000	Gear motor, step		
	419-407-000	Step motor for optics		
	9604500170	Step motor for spindle		
	413-246-000	Pump	Repl. 419-598-000	
	452-091-000	Belt, drive		
	452-150-000	Tooth belt, 8MM T5	Repl. 452-101-000	
	452-109-000	Tooth belt, 3MR B=6 L=510		
	452-110-000	Tooth belt, 3MR B=6 L=270		
	452-111-000	Drive belt, 118MXL		
	452-113-000	Drive belt, MXL Z67 B=6.4		
	452-141-000	Drive belt.		
	459-791-000	Threaded hose, cou. 3/4"		
	459-792-000	Threaded hose, cou. 1/2"		

<i>Pos.</i>	<i>Part No.</i>	<i>Designation</i>	<i>Notes</i>	<i>C</i>
		<b>Accessories/Kits:</b>		
	<b>300169</b>	<b>Kicker output kit</b>		
	213-083-000	Upgrade kit, old to new style vacuum motor	New part	
	9200900100	Adaptec 2944UW	New part	
	200-992-000	Drum sensor adjustment kit	New part	
	300019	Fan kit for processor	New part	
	049-447-000	FRm Guide for Typer I processor	New part	
	300169	Kicker motor kit	New part	
	411-425-000	RS232 cable for Dotmonitor and processor	New part	
	043-431-000	Jam Knife	New part	
	6600250070	SCSI cable	New part	
	067-180-000	Power chord J	New part	
	067-181-000	Power chord G	New part	
	067-182-000	Power chord GB	New part	

**Explanation**

Pos. No.	Part No.	Designation	Notes	C
<b>01</b>	<b>079-028-000</b>	<b>Step motor, assy.</b>		
	<del>254-105-000</del>	<del>Pulley.</del>	3	
	254-110-000	Belt.		
02	220-398-000	Drive roller, Magazine.		
	030-151-000	Pulley.		
03	022-611-000	Roller.		
04	212-806-000	Sensor, Empty roll or park, type B, assy.		
05	067-051-000	Motor, DC, compl.		
06	063-645-000	Finger nut.		
07	035-414-000	Split.		
08	254-073-000	Shaft, assy.		
09	056-293-000	End cap.		
10	052-052-000	Spike.		
	079-125-000	Spool shaft, assy.		

**Parts (1) listed below an assembly number (2) is main parts that is included in the assembly number**

**Assembly, subassembly or parts that is not shown, but can be ordered.**

**When Technical informations are released, and new are replacing (3) old numbers . Write in the new number yourself.**

"C" indicates consumable spareparts



Blank